

Gartenhaus Basic

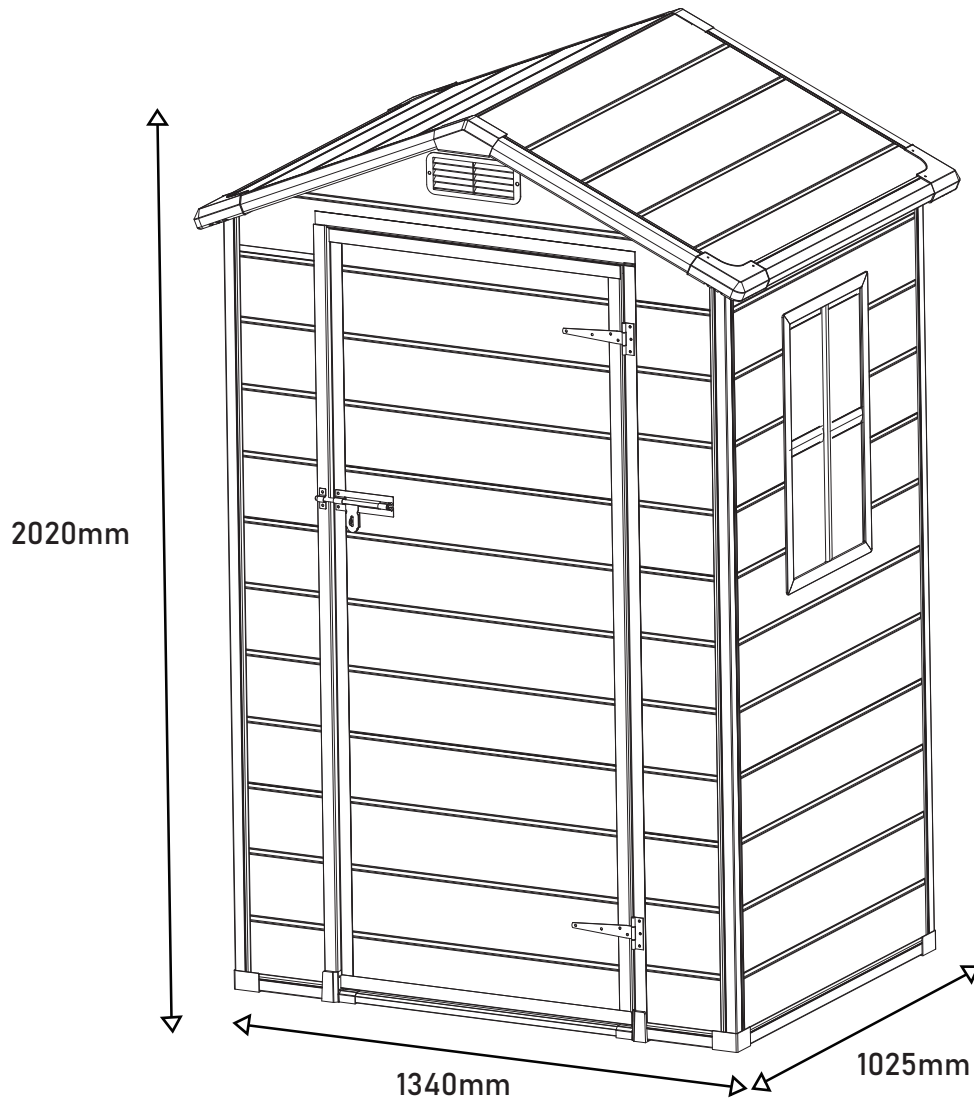

ARTIKEL-NR
6015033/00

DE**SICHERHEITSHINWEISE****WICHTIG! SORGFÄLTIG LESEN UND FÜR SPÄTERES
NACHSCHLAGEN AUFBEWAHREN**

Dieses Möbelstück ist für den Hausgebrauch bestimmt.

Für den Gebrauch im Freien.

Zur Selbstmontage.

Vor der Montage überprüfen, ob alle Befestigungselemente und Teile vorhanden und in einwandfreiem Zustand sind.

Die Möbel nicht montieren oder benutzen, wenn bestimmte Elemente defekt, beschädigt sind oder fehlen. Nur vom Hersteller zugelassene Teile verwenden.

Nur die mitgelieferten oder empfohlenen Werkzeuge verwenden.

Die Befestigungselemente mit dem mitgelieferten oder empfohlenen Werkzeug gut festziehen.

Durch unsachgemäße Montage, Lagerung oder Handhabung können die Verbindungsstücke und/oder Teile brüchig werden.

Kleine Kinder sind während der Montage fernzuhalten. Es sind kleine Teile vorhanden, die verschluckt werden können.

Alle Verbindungselemente sollten immer richtig angezogen und regelmäßig überprüft und bei Bedarf nachgezogen werden.

EN**SAFETY INFORMATION****IMPORTANT, RETAIN FOR FUTURE REFERENCE:
READ CAREFULLY**

This furniture is for domestic use.

For outdoor use.

Self-assembly required.

Check that all of the hardware and parts are present and in good condition before starting assembly.

Do not assemble or use the furniture if any of the parts are broken, damaged or missing, and only use parts approved by the manufacturer.

Only use tools that are supplied or recommended.

Firmly tighten the fasteners using the supplied or recommended tools.

Improper assembly, cribbing or handling can lead to assemblies and/or parts becoming weakened.

Keep young children away during assembly. The product contains small parts that could be ingested.

All joints should always be properly tightened and regularly checked, and retightened, if necessary.

SITE PREPARATION | PRÉPARATION DU SITE | PREPARACIÓN DEL LUGAR | VORBEREITUNG DES AUFSTELLUNGSORTES | VOORBEREIDING VAN HET TERREIN | PREPARAZIONE DEL LUOGO DI ASSEMBLAGGIO | PREPARAÇÃO DO LOCAL

Level the ground surface | Nivelez la surface du sol | Nivele la superficie del suelo | Ebnen Sie die Bodenoberfläche | Maak de bodem vlak | Livellare la superficie del terreno | Nivele a superfície do solo

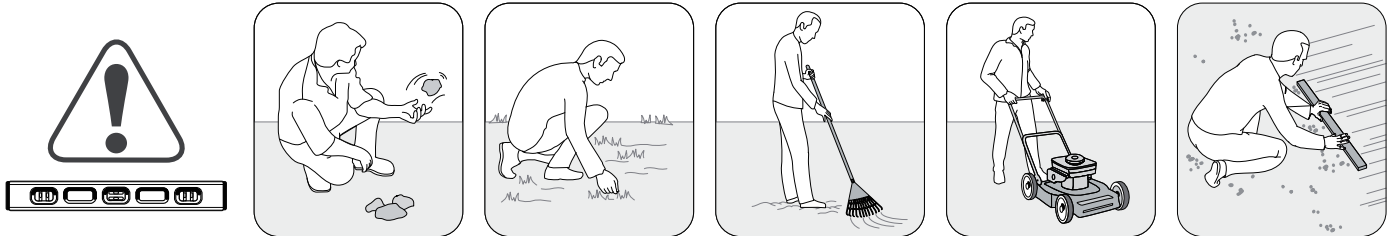

Recommendation: Construct a wooden or concrete base as a foundation | Recommandation: fabriquez une base en bois ou en béton en guise de fondation | Recomendación: construya una base de madera o de cemento a modo de cimiento | Empfehlung: Bauen Sie als Fundament eine Grundfläche aus Holz oder Beton | Aanbeveling: maak een houten of betonnen ondergrond als fundering | Raccomandazione: Costruire una base di legno o di cemento come fondamenta | Recomendação. Construa uma base de madeira ou de cimento como fundação

Recommendation: Construct a wooden or concrete base as a foundation

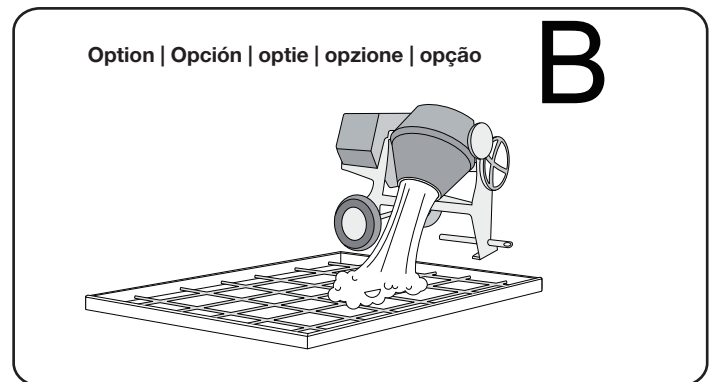
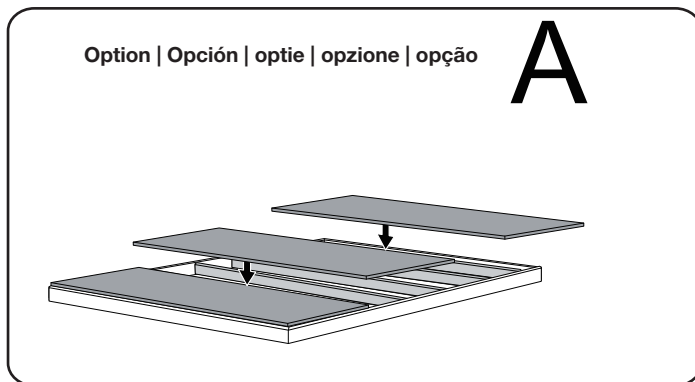

External floor measurements are: | Les mesures externes de la étage sont: | Las medidas del suelo externo son: | Die Außen-Bodenmaße betragen: | De afmetingen van de externe vloer zijn: | Le dimensioni esterne del pavimento sono: | As medidas externas do chão são:

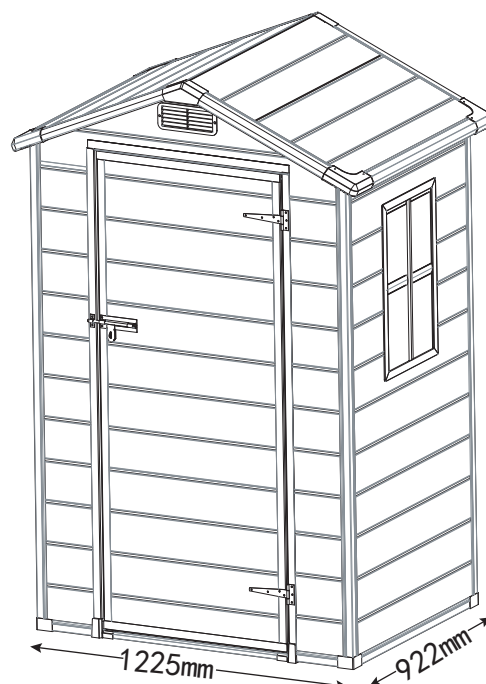

BEFORE STARTING ASSEMBLY | AVANT DE COMMENCER LE MONTAGE | ANTES DE EMPEZAR EL ARMADO | VOR MONTAGEBEGINN | VOORDAT U BEGINT TE MONTEREN | PRIMA DI INIZIARE L'ASSEMBLAGGIO | ANTES DE INICIAR A MONTAGEM

Read the care and safety guidelines at the end of this manual | Check to ensure that there are no missing or damaged parts BEFORE starting or arranging assembly | Remove all parts from the package(s) and spread them out on a clean work surface | Review all assembly instructions | Assemble all the parts according to the directions in this manual. Do not skip any steps.

Lisez les instructions de précaution et de sécurité à la fin de ce manuel | Assurez-vous qu'il n'y a pas de pièces manquantes ou endommagées AVANT de commencer ou d'organiser l'assemblage | Retirez toutes les pièces du/des paquet(s) et étalez-les sur une surface de travail propre | Lisez toutes les instructions de montage | Assemblez toutes les pièces selon les instructions de ce manuel. Ne sautez aucune étape.

Lea las instrucciones de precauciones y seguridad que están al final de este manual | Asegúrese de que no faltan piezas ni están dañadas ANTES de comenzar o disponer el montaje | Saque todas las piezas del paquete o paquetes y póngalas sobre una superficie de trabajo limpia | Revise todas las instrucciones de montaje | Monte todas las piezas según las instrucciones de este manual. No se saltee ningún paso.

Lesen Sie die Sicherheitsrichtlinien am Ende des Benutzerhandbuchs durch | Prüfen Sie bitte VOR dem Zusammenbau, dass keine Teile beschädigt sind oder fehlen | Nehmen Sie alle Teile aus der Verpackung und breiten Sie sie auf einer sauberen Arbeitsfläche aus | Gehen Sie noch einmal die komplette Aufbauanleitung durch | Bauen Sie alle Teile entsprechend der Anleitung in diesem Handbuch zusammen. Lassen Sie dabei keinen Arbeitsschritt aus.

Lees de richtlijnen voor zorg en veiligheid achterin deze handleiding | Controleer dat er geen onderdelen mankeren, of beschadigd zijn, VOORDAT u met de montage begint | Haal alle onderdelen uit het pakket (of uit de pakketten) en leg ze op een schoon werkoppervlak | Bekijk alle montagehandleidingen | Monteer alle onderdelen volgens de aanwijzingen van deze handleiding. Sla geen stappen over.

Leggere le linee guida di assistenza e sicurezza alla fine di questo manuale | Assicurarsi che non ci siano parti mancanti o danneggiate PRIMA di iniziare l'assemblaggio | Estrarre tutti i componenti dall'imballo e posizzarli su una superficie di lavoro pulita | Consultare tutte le istruzioni di montaggio | Assemblare tutti i componenti secondo le istruzioni contenute nel manuale. Non saltare nessuna fase.

Leia as diretrizes de cuidados e segurança que constam da parte final deste manual | Verifique para se assegurar de que não há peças em falta ou danificadas ANTES de começar a preparar a montagem | Retire todas as peças da embalagem e espalhe-as numa superfície de trabalho limpa | Reveja todas as instruções de montagem | Monte todas as peças de acordo com as instruções do manual. Não salte quaisquer passos.

REQUIRED TOOLS | OUTILS EXIGÉS | HERRAMIENTAS NECESARIAS | BENÖTIGTE WERKZEUGE | BENODIGD GEREEDSCHAP | ATTREZZATURA OCCORRENTE | FERRAMENTAS NECESSÁRIAS



SPATULA | SPATULE | ESPÁTULA | SPACHTEL | SPATEL | SPATOLA | ESPÁTULA

- Use spatula (part “SG8”) for easier insertion of panel into profile.
- Utilisez la spatule (partie “SG8”) pour une meilleure insertion du panneau dans le profil.
- Utilice una espátula (pieza “SG8”) para una mejor inserción del panel en el perfil.
- Benutzen Sie den Spachtel (Bezeichnung “SG8”), um die Platten leichter in die Nut einführen zu können.
- Gebruik spatel (onderdeel SG8) voor het gemakkelijk invoeren van het paneel in het profiel.
- Utilizzare la spatola (parte SG8) per inserire il pannello più facilmente nel profilo.
- Utilize uma espátula (peça “SG8”) para facilitar a inserção do painel no perfil.

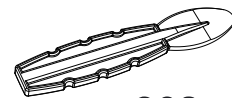

SG8 x2



ASSEMBLY REQUIRES TWO PEOPLE | LE MONTAGE DOIT ÊTRE EFFECTUÉ PAR DEUX PERSONNES | SE NECESITAN DOS PERSONAS PARA ARMARLO | ZWEI PERSONEN ZUR MONTAGE NOTWENDIG | MONTAGE VEREIST TWEE PERSONEN | L'ASSEMBLAGGIO RICHIEDE DUE PERSONE | A MONTAGEM EXIGE DUAS PESSOAS

PARTS LIST | TEILELISTE

NO. / Nr.	PART. / Teil	QTY. / Menge	CTN. / Karton
EW1-1		2	1
EF1-1		1	1
EW1-2		1	1
ER1-4		1	1
EW3-1		3	1
EW3-2		1	1
EW3-3		1	1
EW3-4		1	1
ED1-2		1	1
ED1-3		1	1
ED1-1		1	1
EW4-1		3	1
M01		2	1
M03-6L		1	1
ER1-1		2	2
EW2-2		1	2
EW2-1		1	2
EF1-2		1	2
EW4-1		1	2
EW4-2		2	2
EA2R		1	2
EA2L		1	2
EA1R		1	2
EA1L		1	2
EA3		1	2
EAP		1	2

NO. / Nr.	PART. / Teil	SIZE / Größe	QTY. / Menge	CTN. / Karton
Drill		Ø3	1	2
Z410		4X10	54	2
ZW413		4X13	16	2

NO. / Nr.	PART. / Teil	QTY. / Menge	CTN. / Karton
SG1		2	1
SG2		4	1
SG6		4	1
SG7-2		1	1
SG7-1		1	1
SG8		2	1
SG9		3	1
SG12		2	1
BY		1	1
SG13		2	1
SG14		4	1
M03-7		1	1
M04		1	1
SG10		1	2
SG101		1	2
SG102		1	2
EA4		1	2
ES1		1	2
EP1		1	2
EP2		2	2
EP3		2	2
EP5		4	2
EP4		1	2
EP7		2	2
EP6		4	2

NO. / Nr.	PART. / Teil	SIZE / Größe	QTY. / Menge	CTN. / Karton
Z420		4X20	94	2
Z425		4X25	4	2



- Use spatula (part "SG8") for easier insertion of panel into profile.
- Please be mindful of the screw size used during installation; using screws that are too long may damage the shed.
- Please ensure the panels are all installed on position before screwing.

- Benutzen Sie den Spachtel (Teil "SG8"), um die Platten leichter in die Nut einführen zu können.
- Stellen Sie sicher, dass die Paneele in der richtigen Position sind, bevor Sie diese verschrauben.
- Achten Sie immer auf die korrekte Schraubenlänge während der Installation; eine falsche Schraube kann den Artikel beschädigen.

PARTS SCHEMATIC | TEILEÜBERSICHT

ROOF PARTS DACH

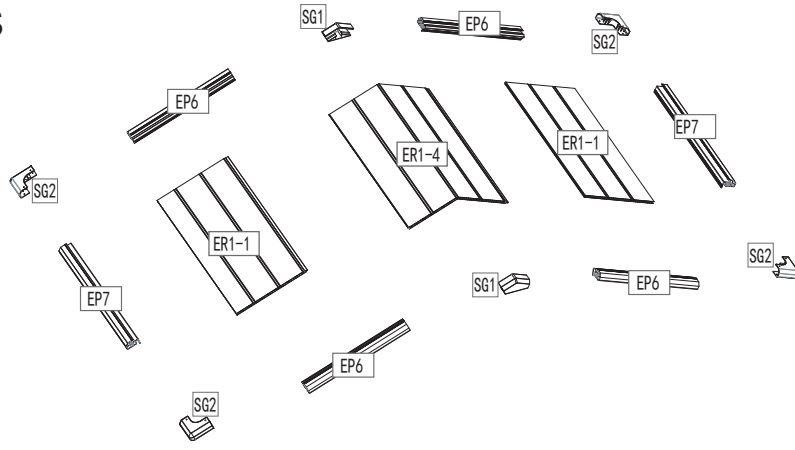

LEFT LINKE WAND

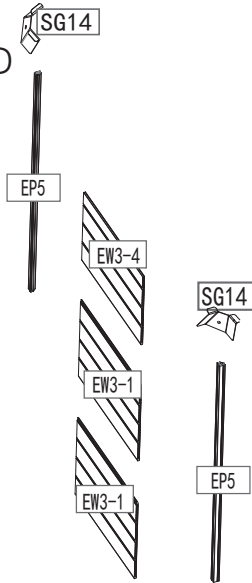

REAR SIDE RÜCKSEITE

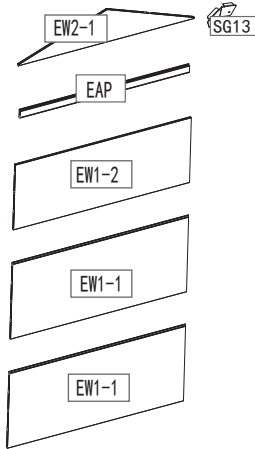

RIGHT RECHTE WAND

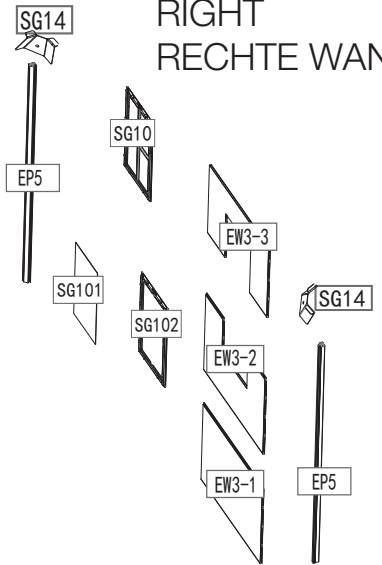

FRONT VORDERSEITE

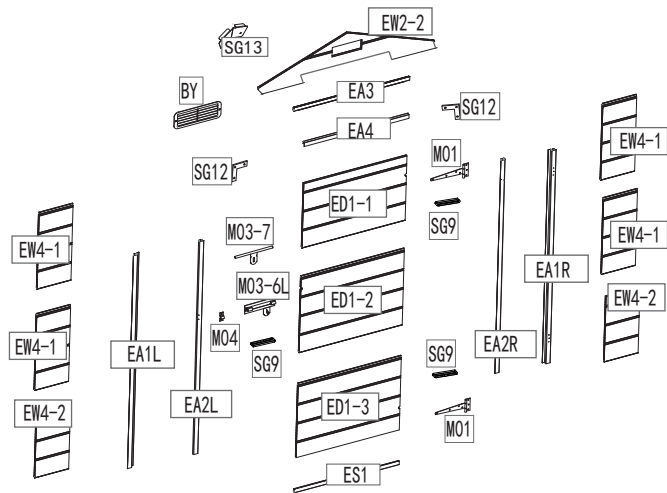

FLOOR PART BODEN

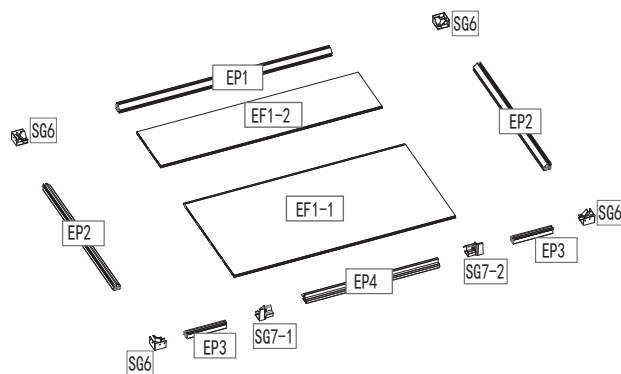

FLOOR ASSEMBLY | BODEN MONTAGE

Use spatula (part "SG8") for easier insertion of panel into profile

Benutzen Sie den Spachtel (Teil "SG8"), um die Platten leichter in die Nut einführen zu können.



Note: The crease line of the floor must be underneath
Achtung: Die glatte Seite muss nach oben zeigen.

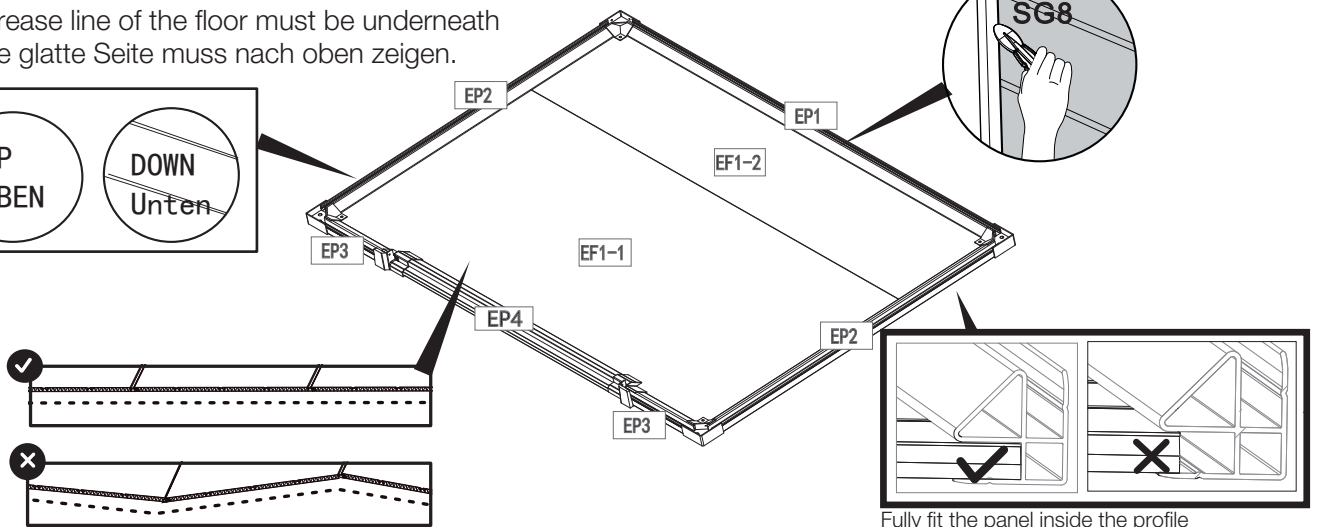
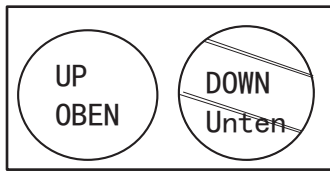

Fully fit the panel inside the profile
Das Paneel muss komplett im Profil liegen.

Step 1 / Schritt 1

1-1

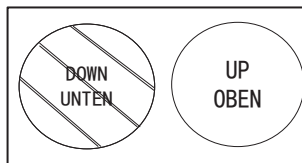
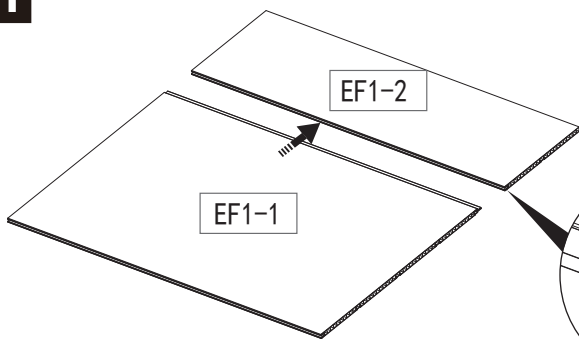

Grain should be down
Glatte Seite oben.

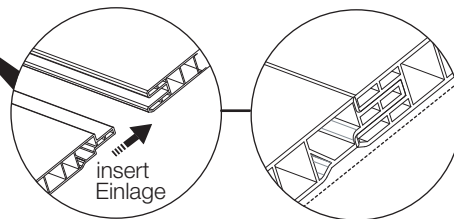

- The floor panels must be straight
- Die Bodenpaneele müssen gerade sein.

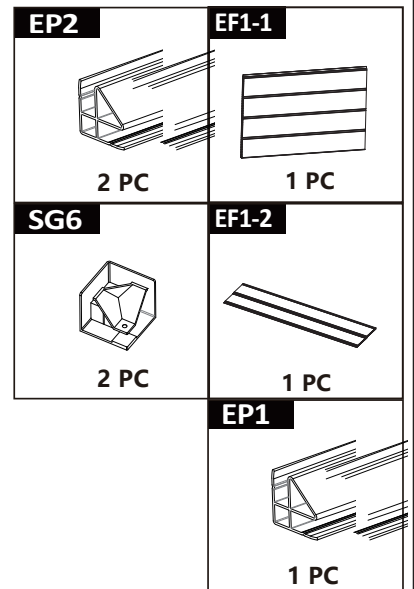

1-2

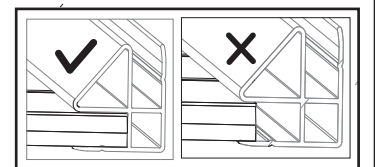
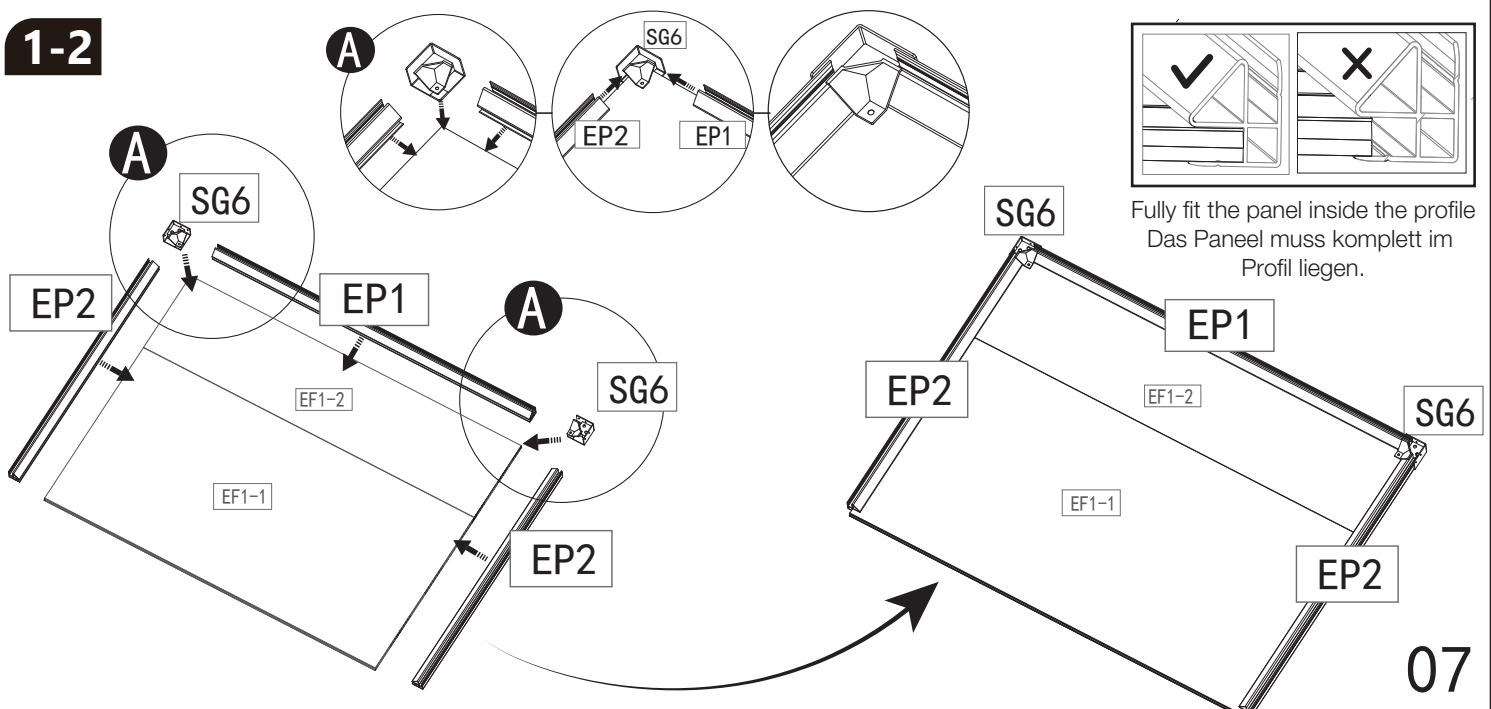

Fully fit the panel inside the profile
Das Paneel muss komplett im Profil liegen.





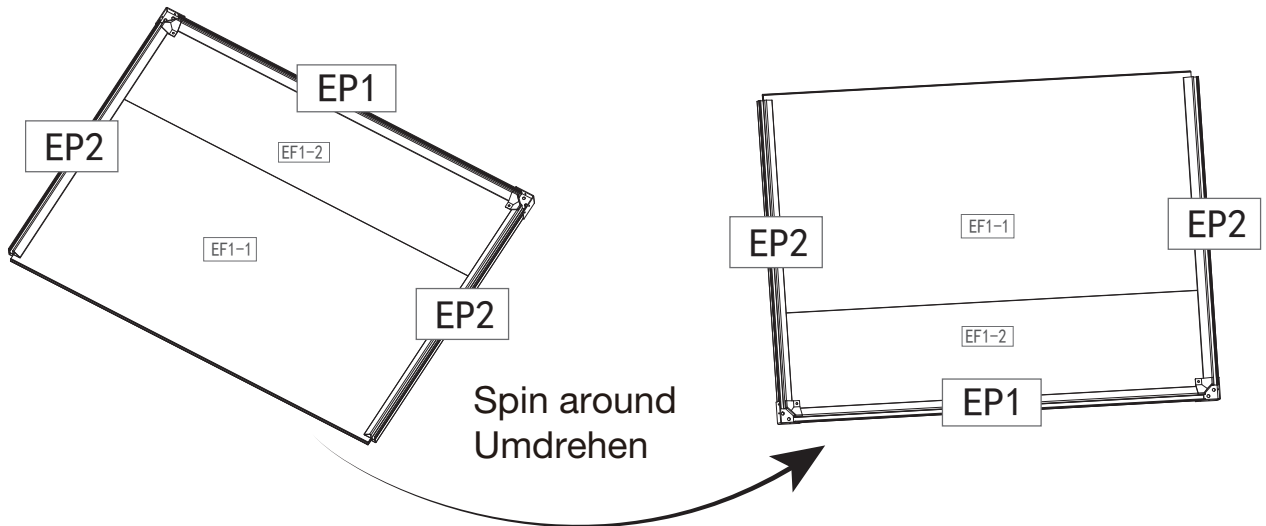

Step 2 / Schritt 2

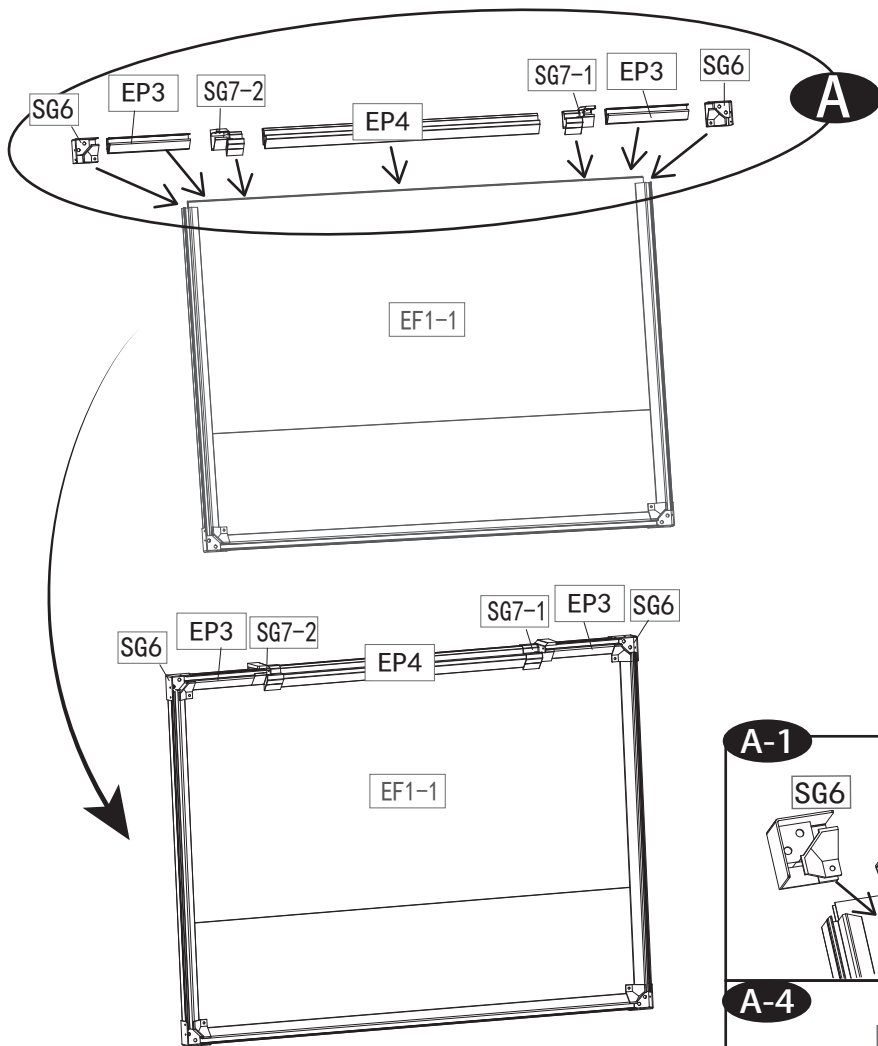
2-1



2-2



SG6  2 PC	EP3  2 PC	SG7-1  1 PC
SG8  1 PC	SG7-2  1 PC	EP4  1 PC

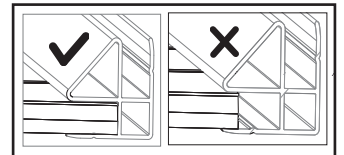

Fully fit the panel inside the profile
Das Paneel muss komplett im Profil liegen.

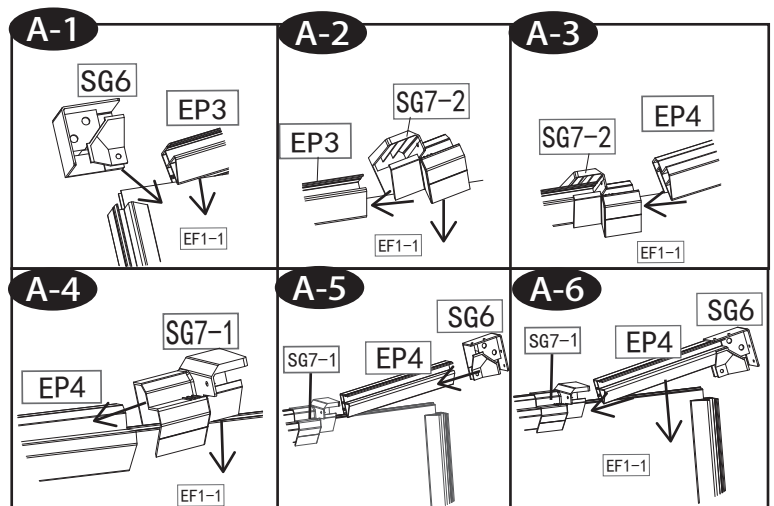

2-3

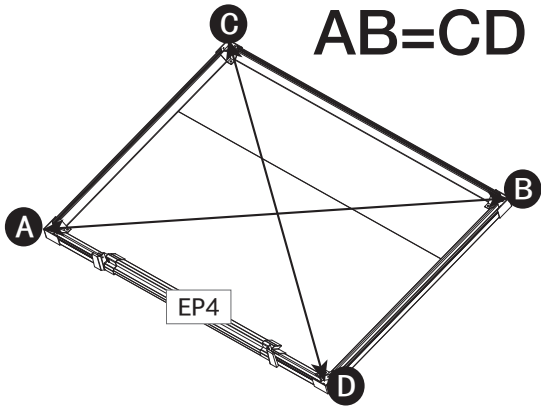

2-4

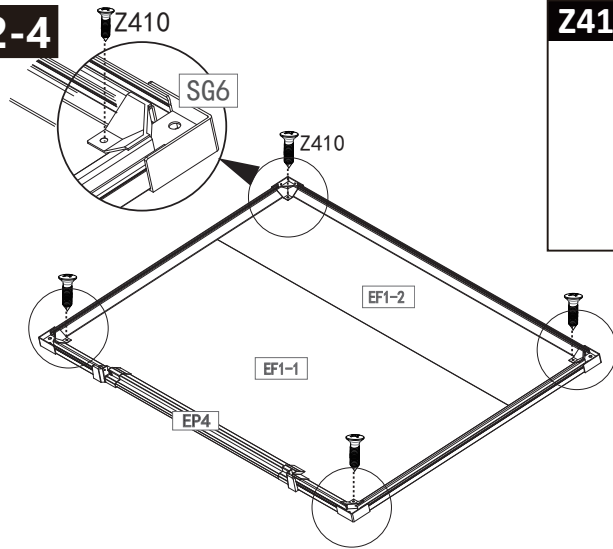

Z410

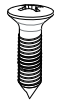

4 PC

Step 3 / Schritt 3

3-1

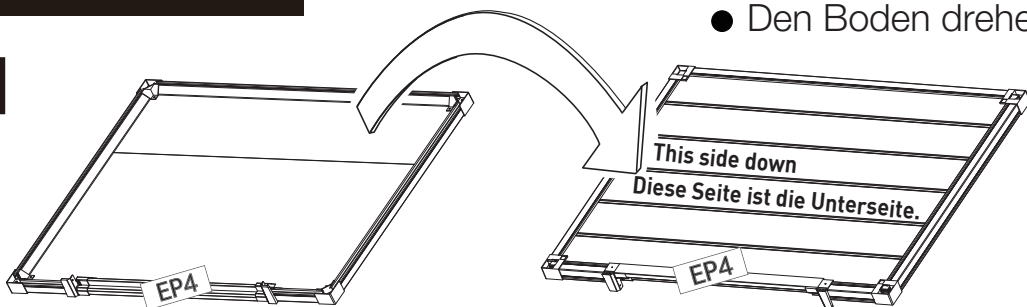

- Turn the floor around
- Den Boden drehen.

Z420

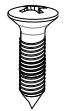

18 PC

3-2

Caution:
Please use Drill  to predrill
a hole at depth 1mm before screw.

Achtung:
Nutzen Sie den Bohrer,  um etwa
1mm Tiefe Löcher vorzubohren, bevor
Sie die Schrauben eindrehen.

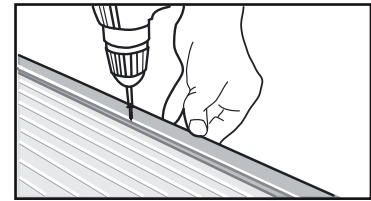
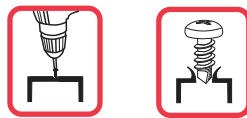

Nail along the marked line on profile
Bleiben Sie innerhalb der markierten Linie.

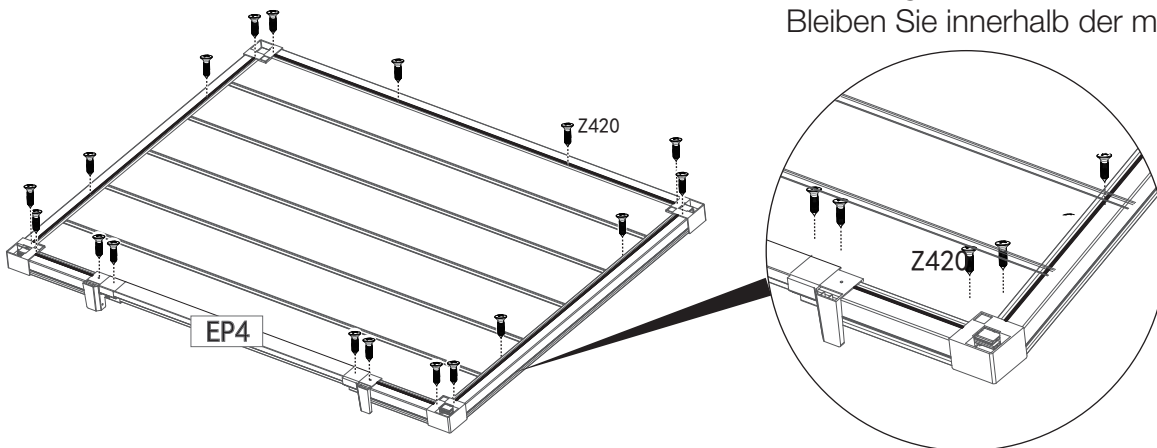

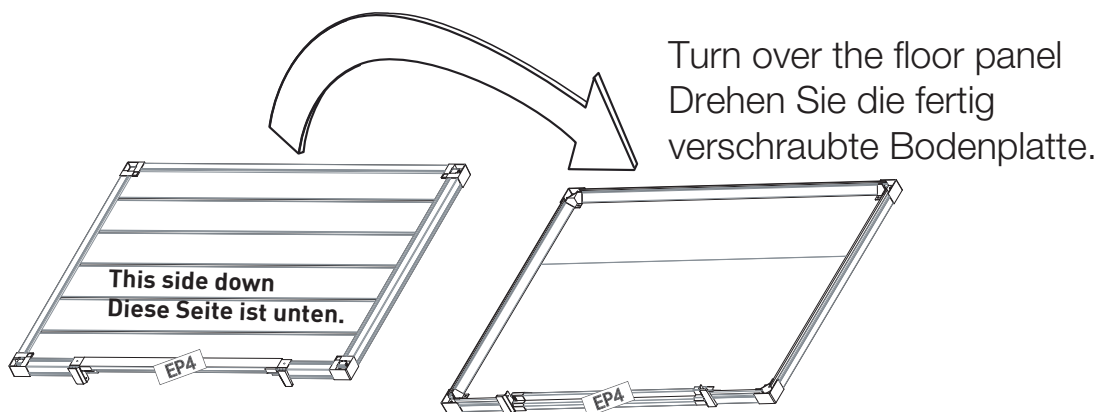

3-3

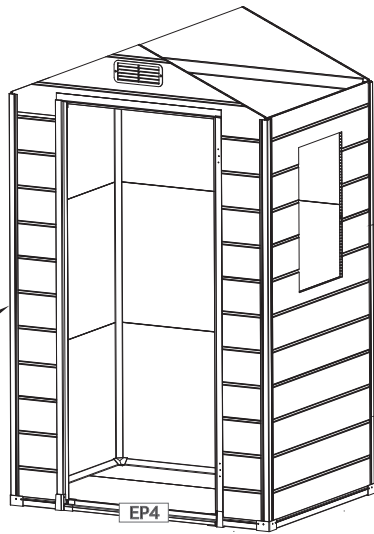

Turn over the floor panel
Drehen Sie die fertig
verschraubte Bodenplatte.

WALL ASSEMBLY | WANDMONTAGE



Use spatula  (part "SG8") for easier insertion of panel into profile

Benutzen Sie den Spachtel  (Teil "SG8"), um die Platten leichter in die Nut einführen zu können.

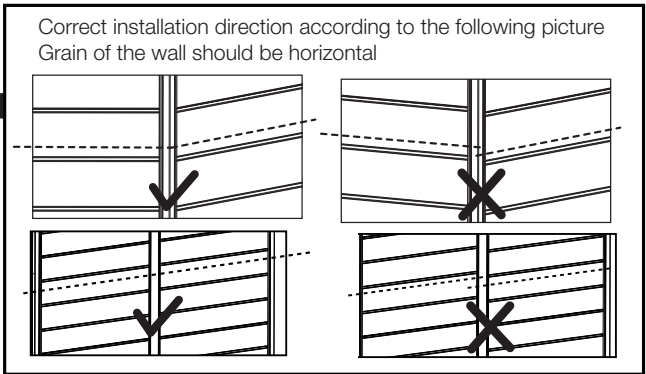
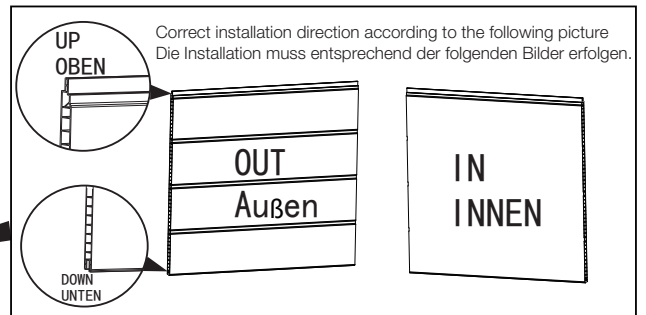

Step 4 / Schritt 4

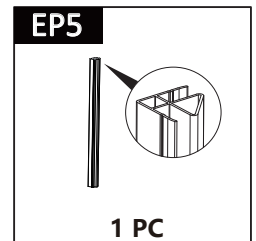
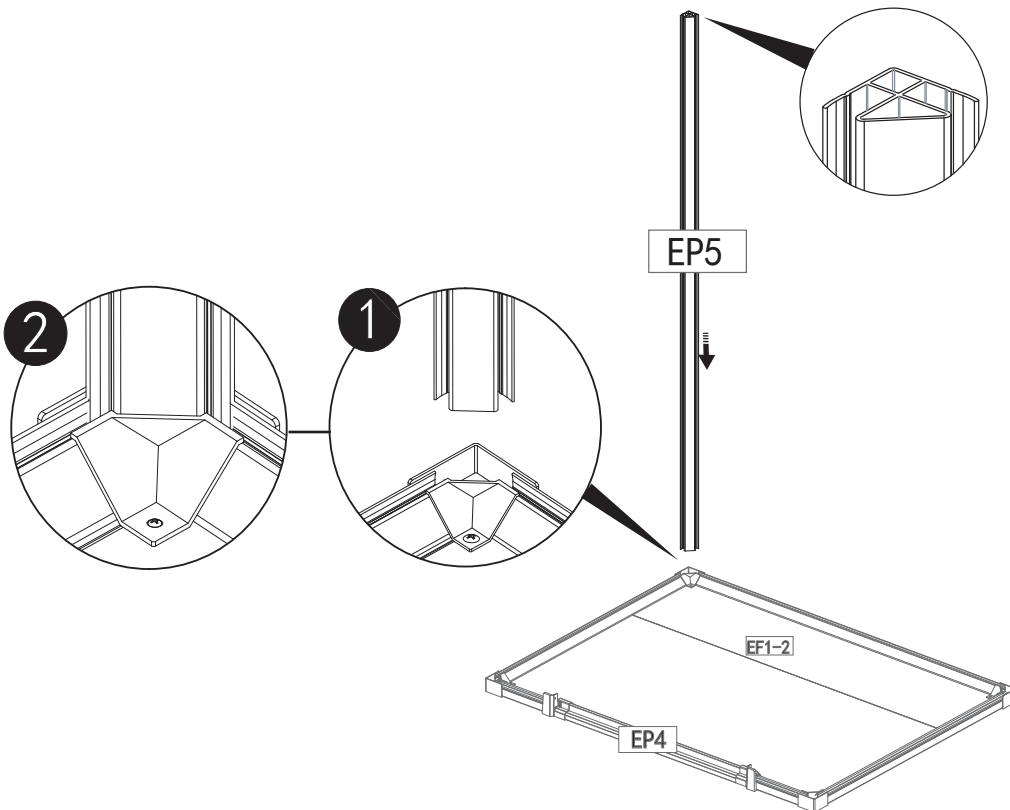

Step 5 / Schritt 5

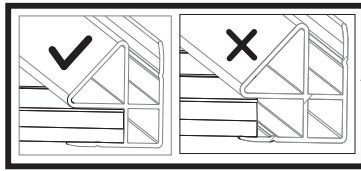

Fully fit the panel inside the profile
Das Paneel muss komplett im Profil liegen.

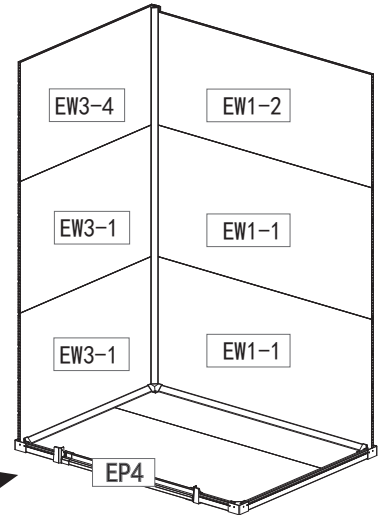
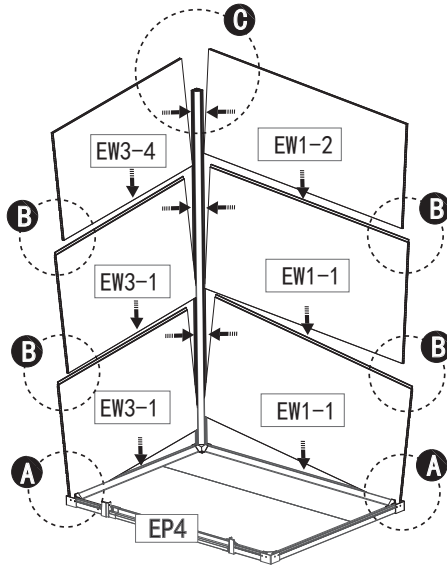
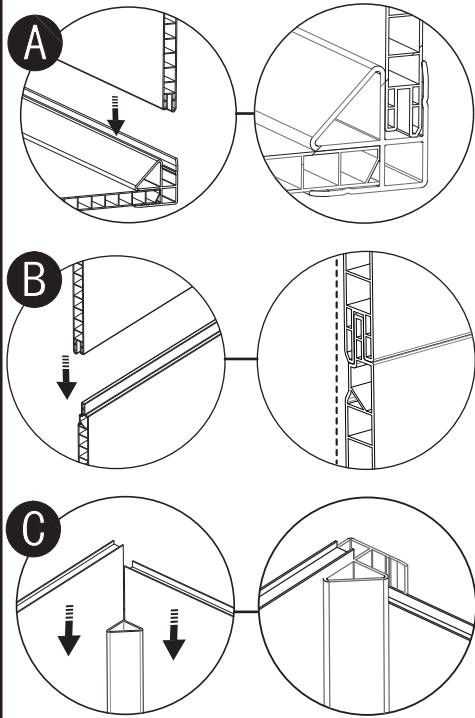
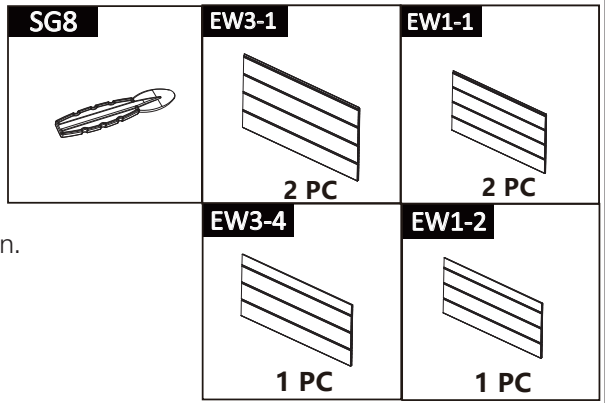

Step 6 / Schritt 6

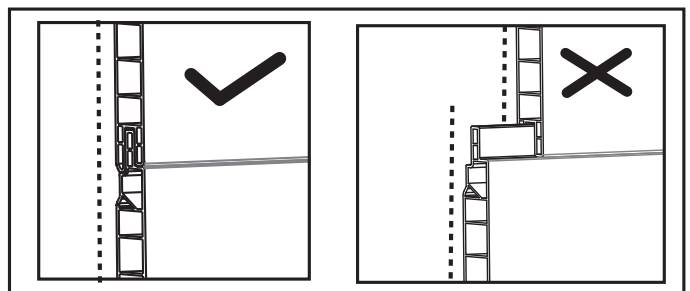
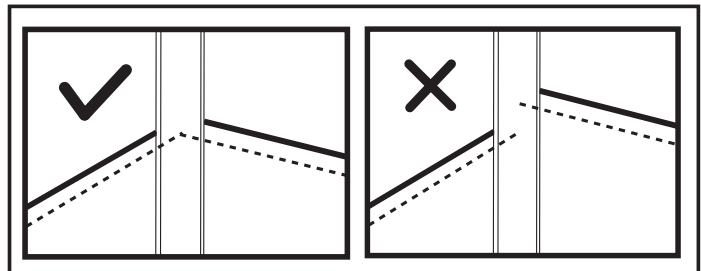
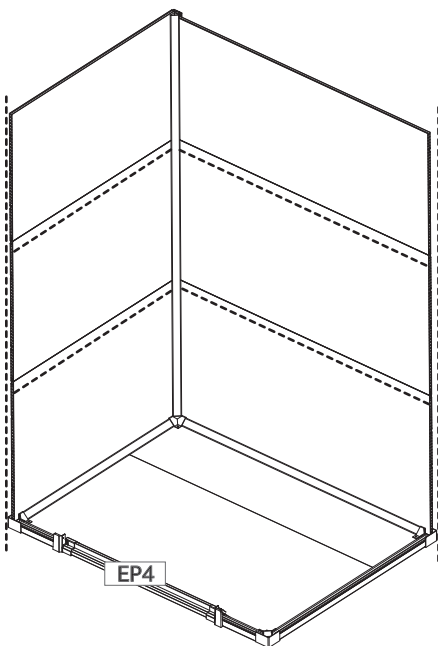

Fully fit the panel inside the profile
The 2 boards must be in line
Die Paneele müssen jeweils parallel abschließen
und gerade ausgerichtet sein.

Step 7 / Schritt 7

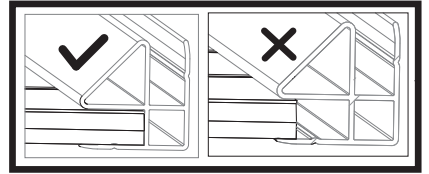

Fully fit the panel inside the profile
Das Paneel muss komplett im Profil liegen.

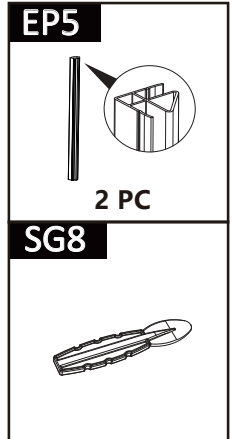
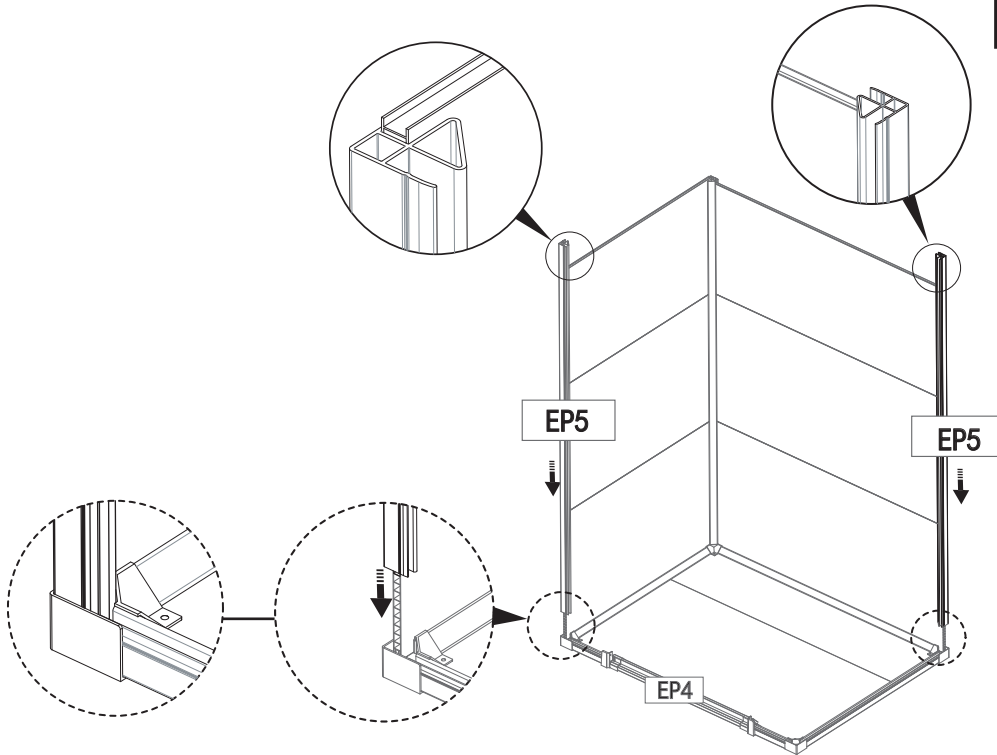

Step 8 / Schritt 8

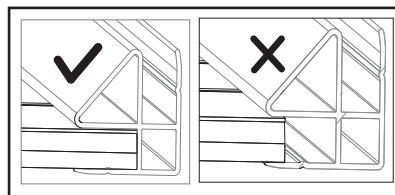

Fully fit the panel inside the profile
Das Paneel muss komplett im Profil liegen.

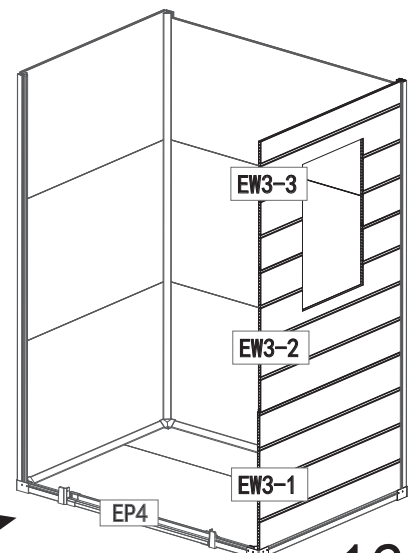
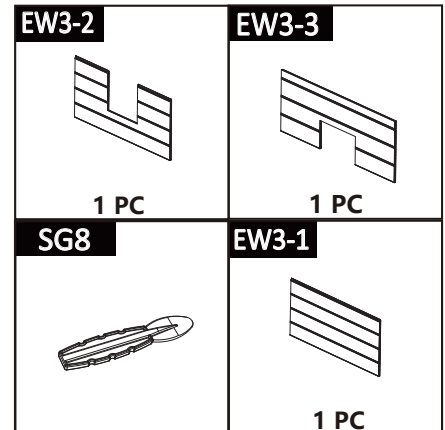
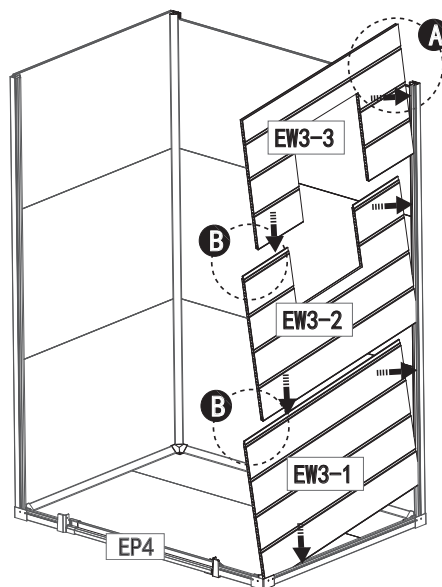
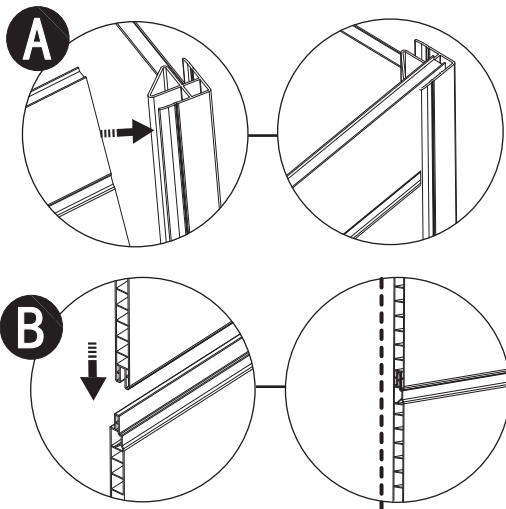

Step 9 / Schritt 9

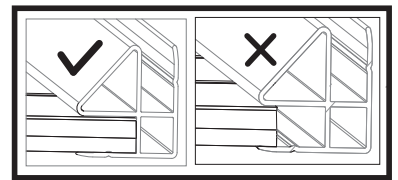
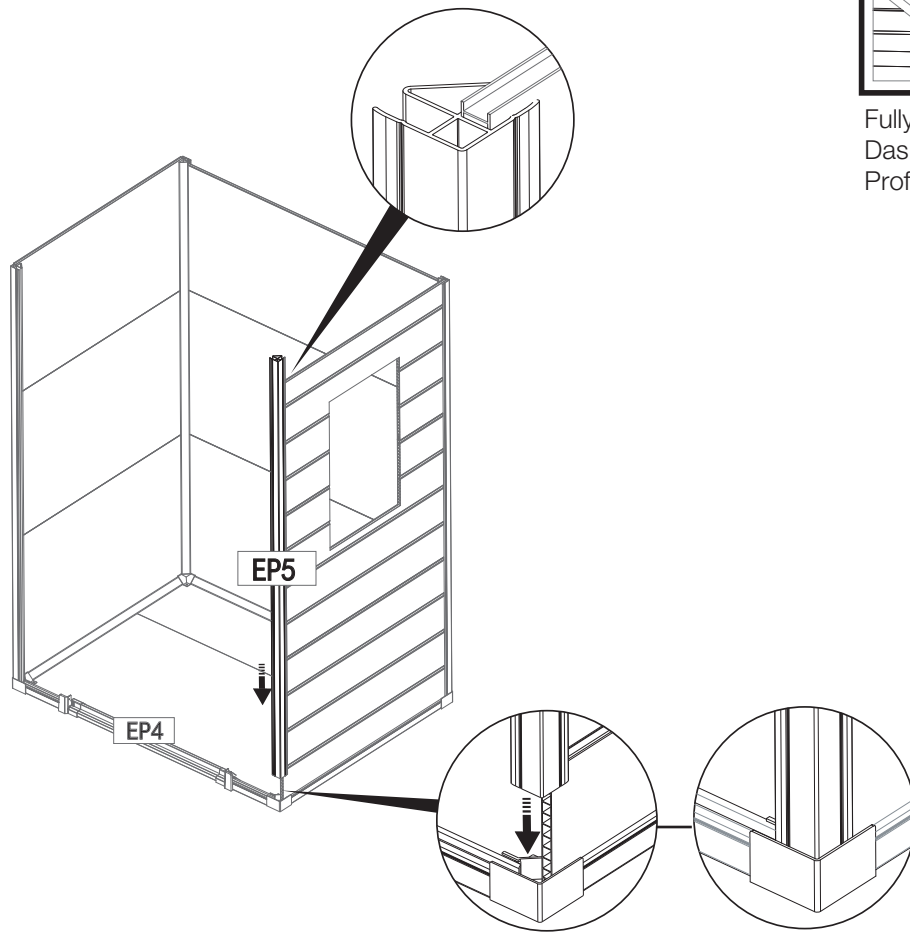

Fully fit the panel inside the profile
Das Paneel muss komplett im
Profil liegen.

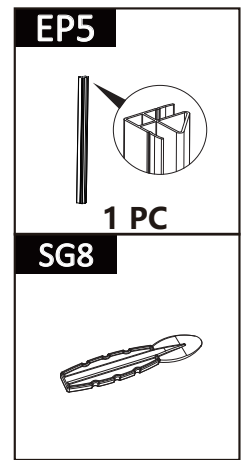

Step 10 / Schritt 10

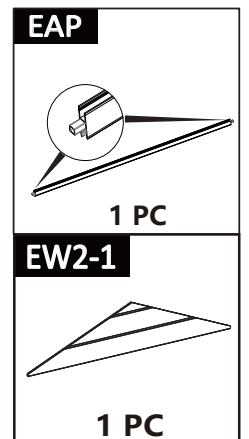
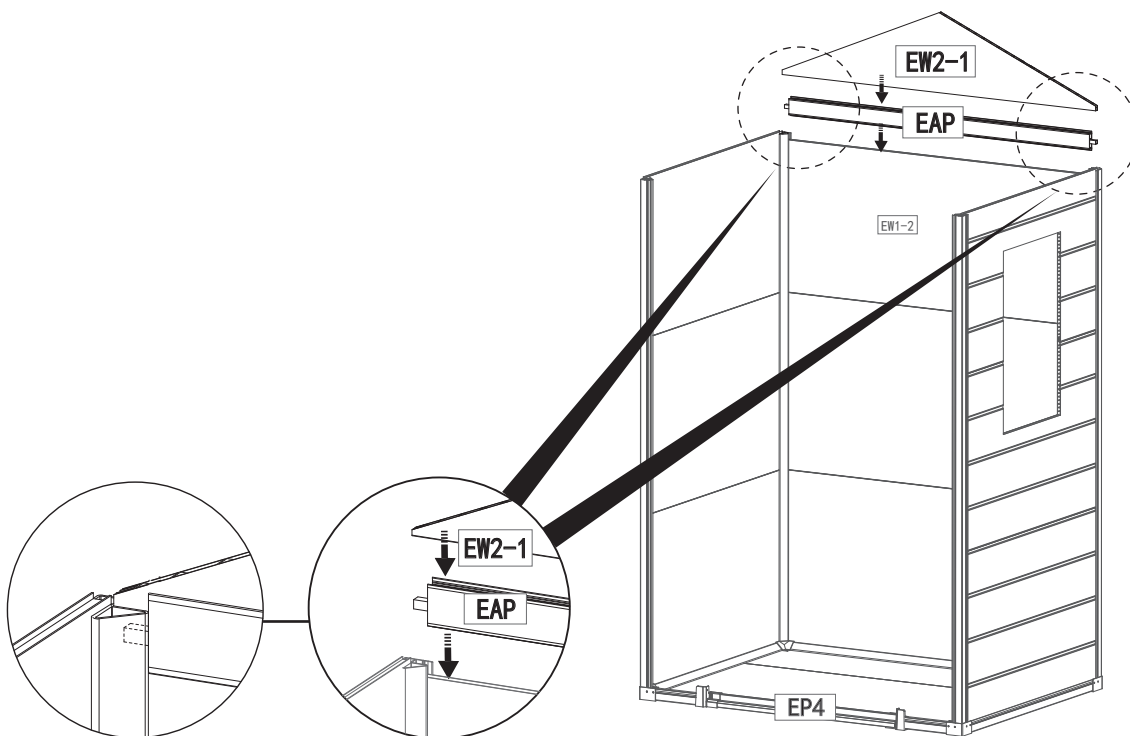

Step 11 / Schritt 11

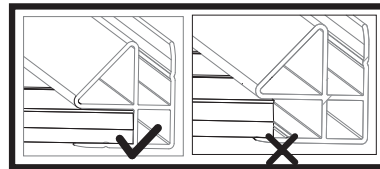
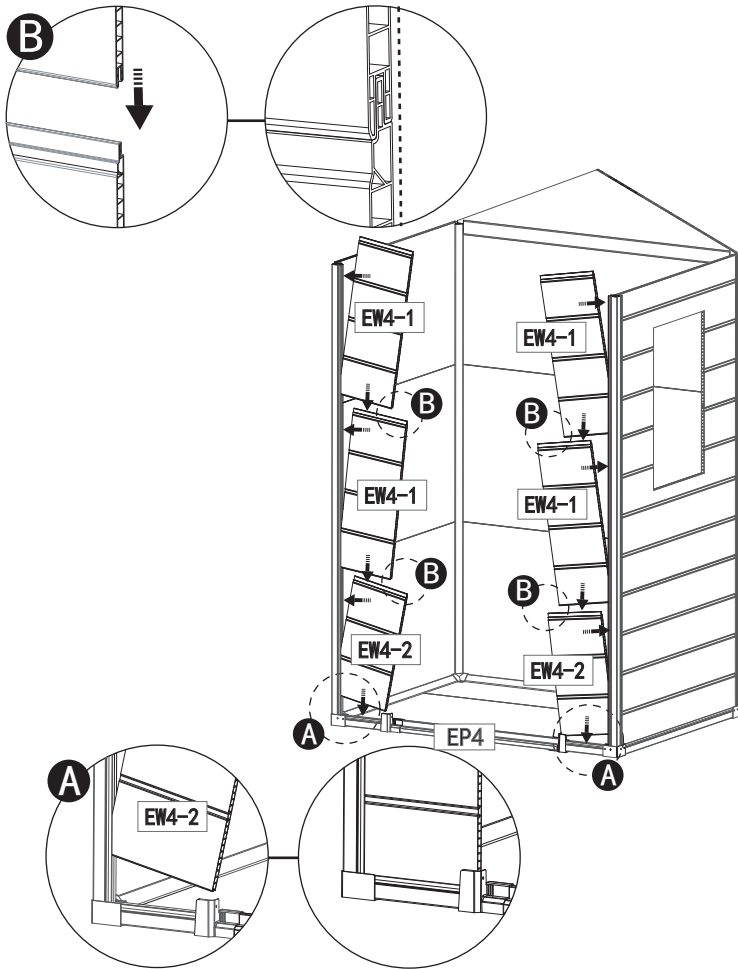

Fully fit the panel inside the profile
Das Paneel muss komplett im Profil liegen.

EW4-2



2 PC

SG8



EW4-1



4 PC

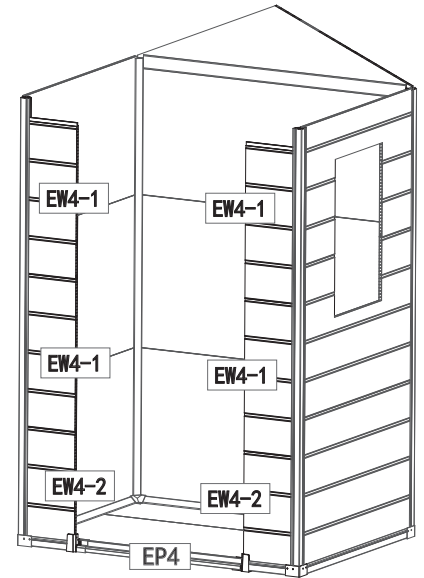

Step 12 / Schritt 12

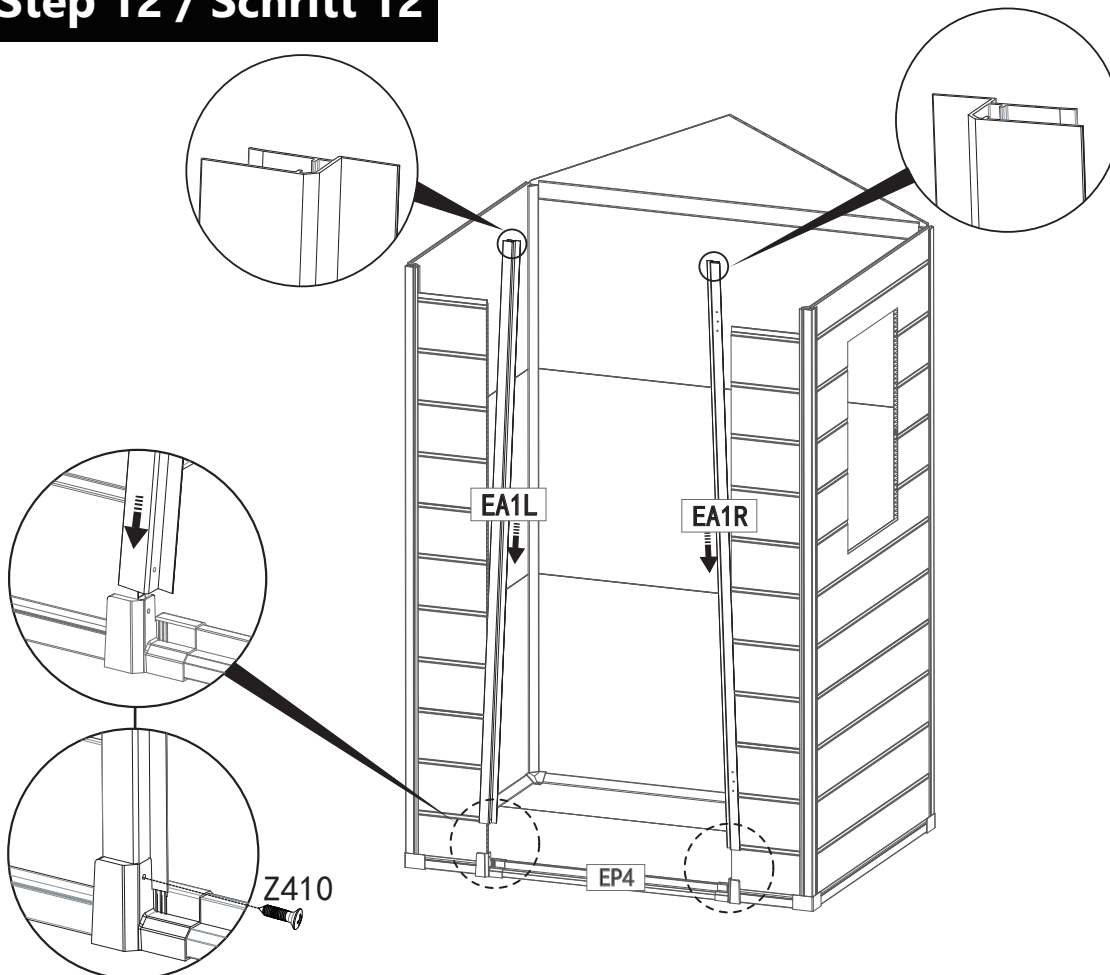

EA1L

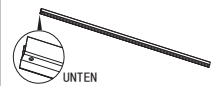

1 PC

EA1R

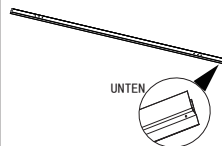

1 PC

Z410



2 PC

Step 13 / Schritt 13

1

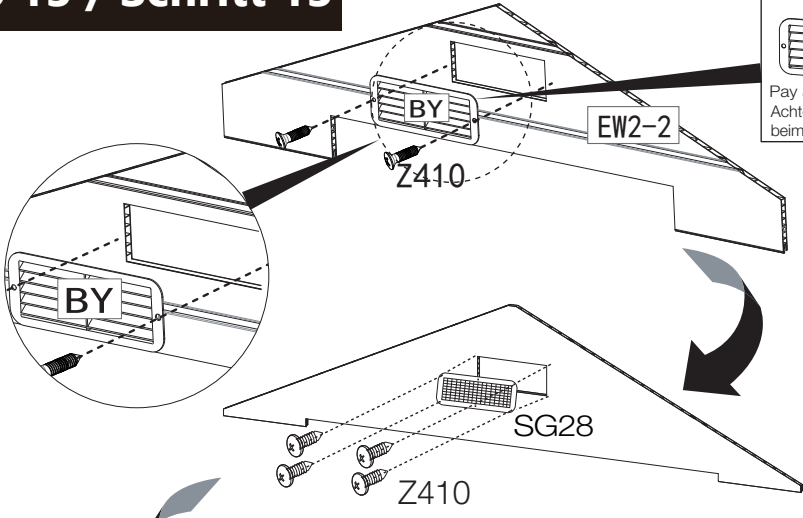

 
 Pay attention to the installation direction of BY.
 Achten Sie auf die korrekte Richtung von Teil BY
 beim Einsetzen.

EW2-2



1 PC

SG28



1 PC

BY



1 PC

EA3

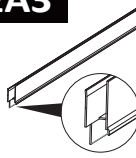

1 PC

Z410



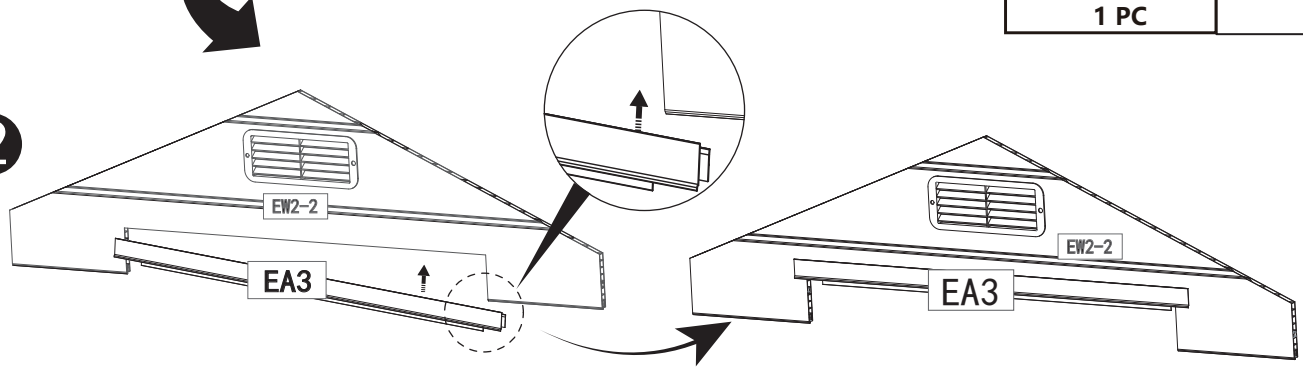

6 PC

2

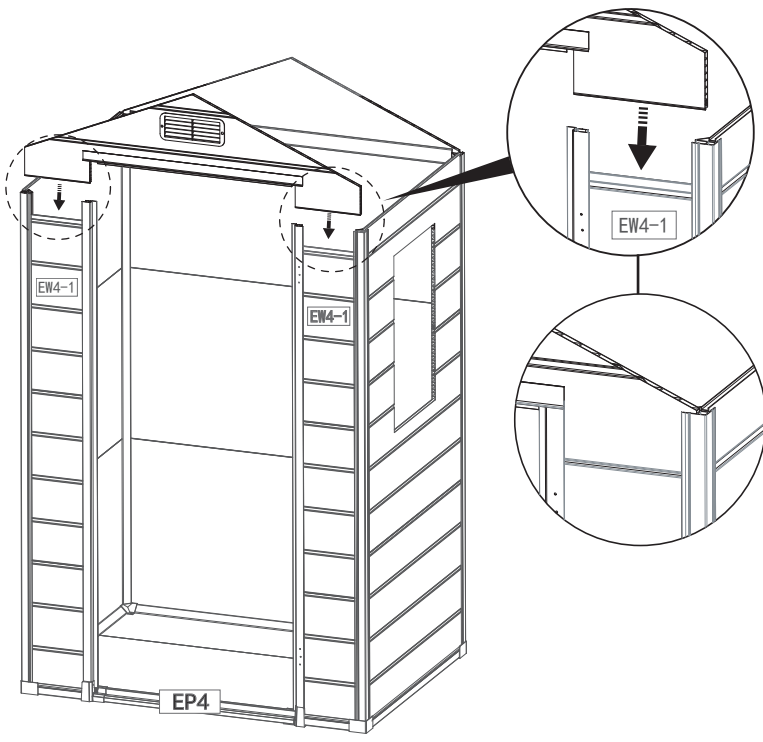

Step 14 / Schritt 14

EW2-2 + EA3



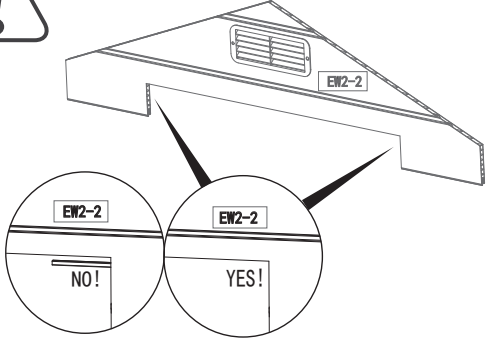

EW2-2 NO!

EW2-2 YES!

Step 15 / Schritt 15

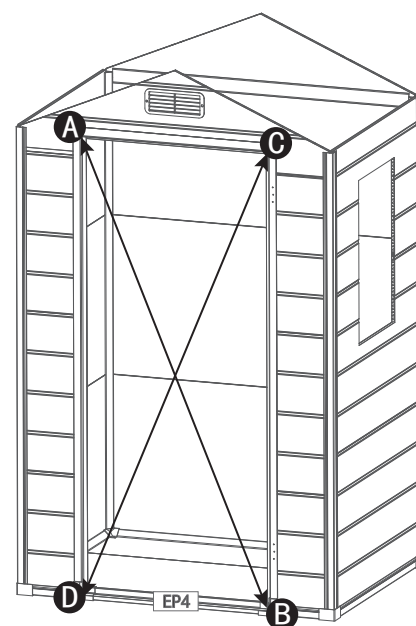
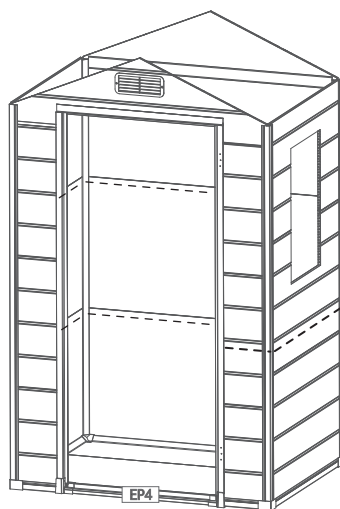
Determine seam alignment.
Kontrollieren Sie nochmal, dass alle Fugen in der gleichen Höhe liegen.



AB=CD

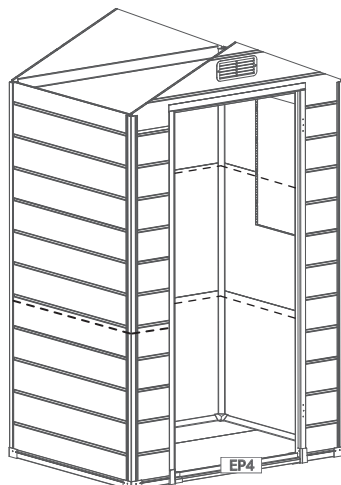
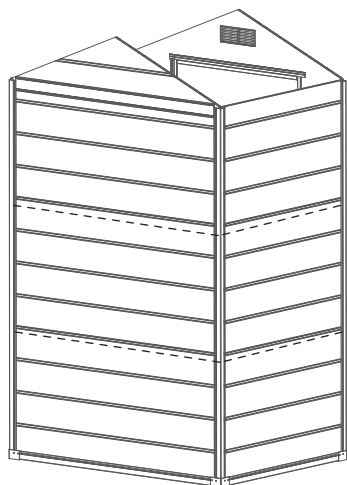

Step 16 / Schritt 16



- fixation after aligning
- Fixieren erst nach korrekter Ausrichtung laut Skizze

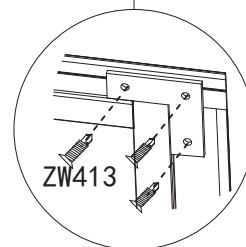
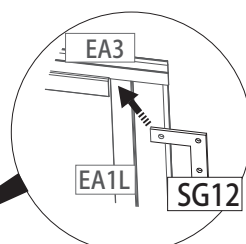
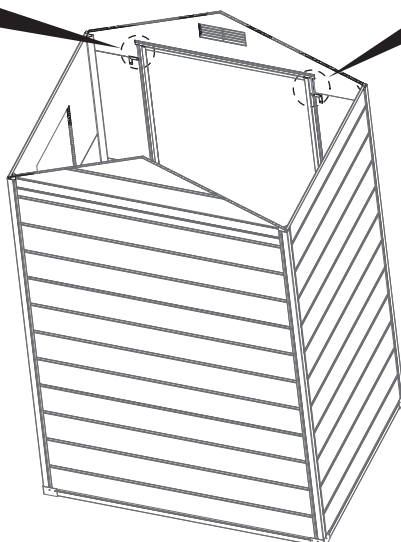
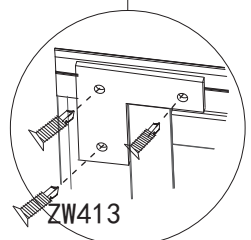
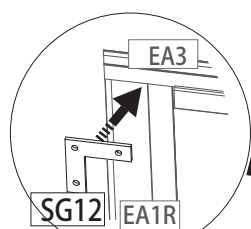
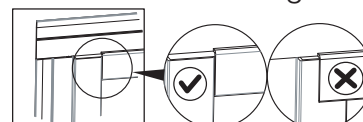
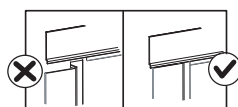

ZW413



6 PC

SG12



2 PC

Step 17 / Schritt 17

Screw when the boards are in position

Wenn alle Teile korrekt in Position sind, können diese nun mit Schrauben fixiert werden.

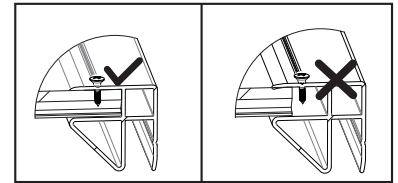

Fully fit the panel inside the profile
Screw along the marked lines in profiles
Das Paneel vollständig in das Profil einsetzen. Entlang der markierten Linien im Profil verschrauben

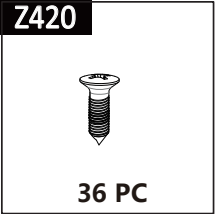
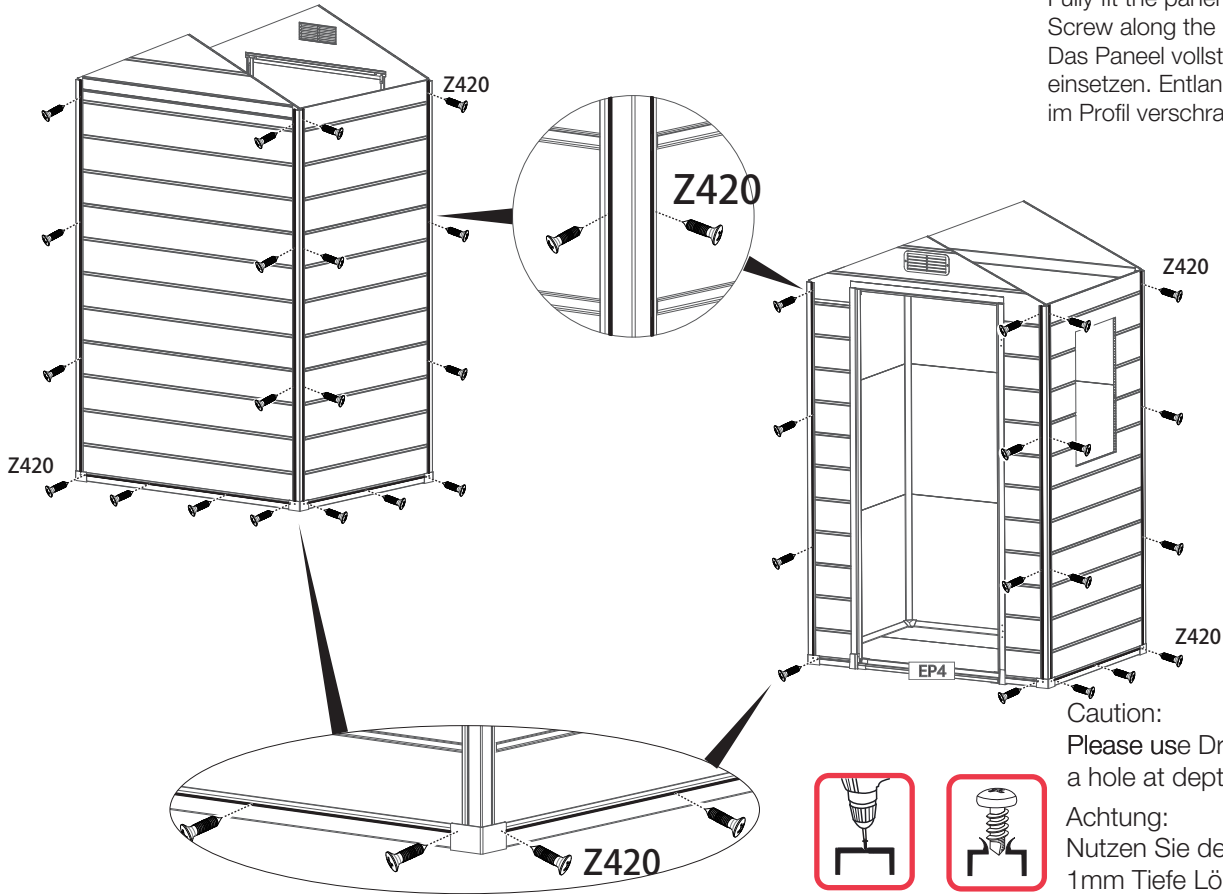

Caution:
Please use Drill to predrill a hole at depth 1mm before screw.

Achtung:
Nutzen Sie den Bohrer, um etwa 1mm Tiefe Löcher vorzubohren, bevor Sie die Schrauben eindrehen.

Step 18 / Schritt 18

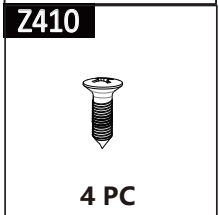
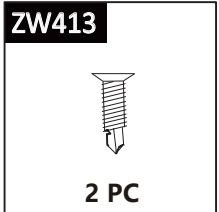
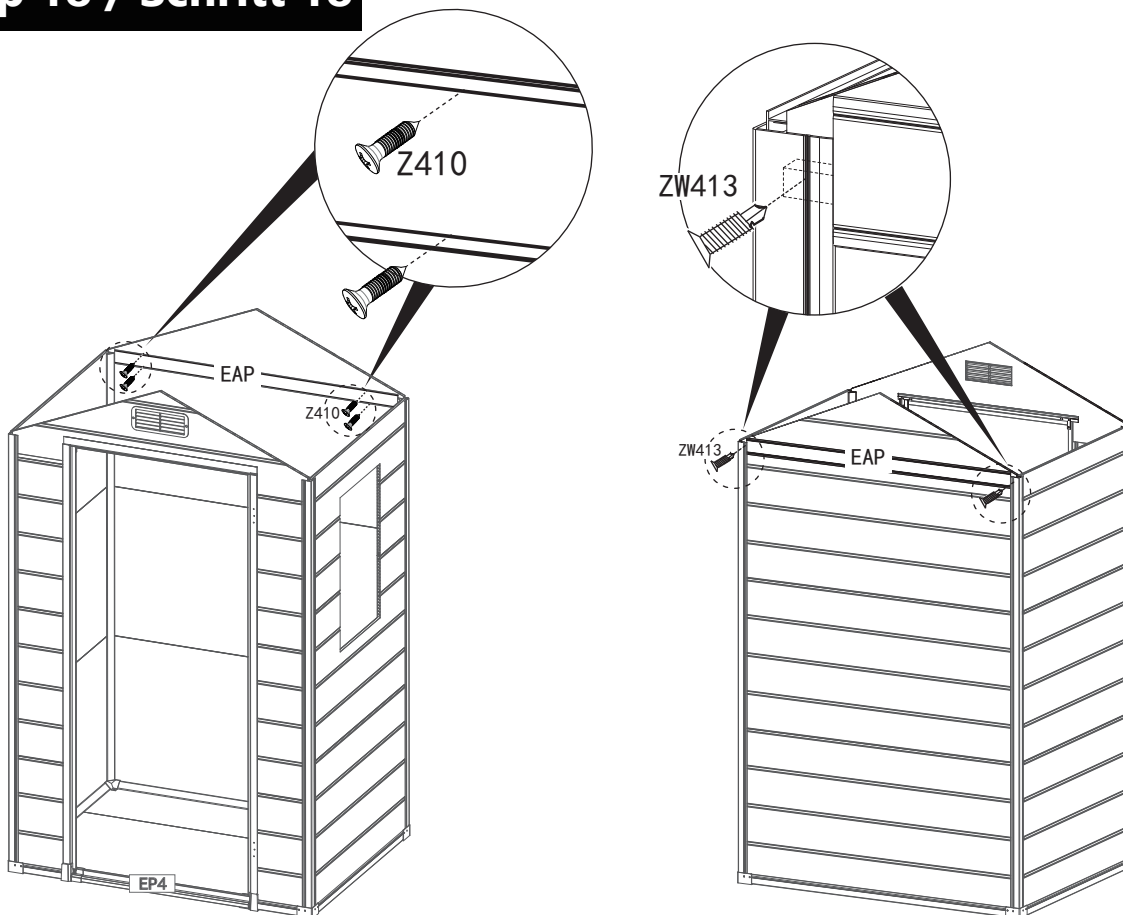

ROOF PARTS | DACHMONTAGE

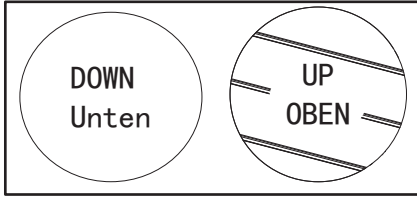

The stripes should be upwards
Die glatte Seite zeigt nach Innen.

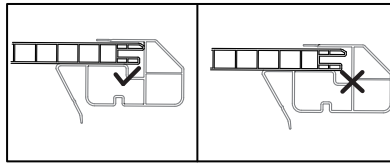

Fully fit the panel inside the profile
Das Paneel muss komplett im
Profil liegen.

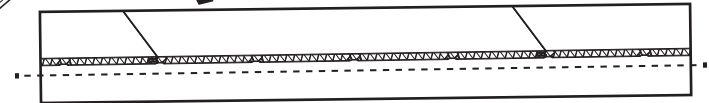
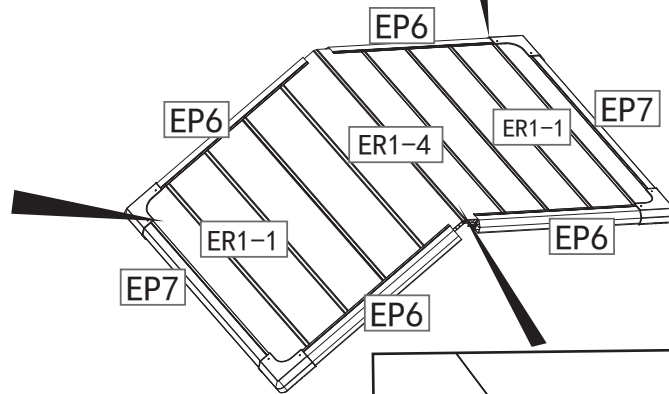
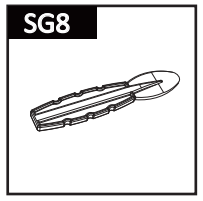
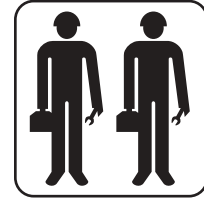

The boards must be straight
Die Paneele müssen gerade ausliegen.

Step 19 / Schritt 19

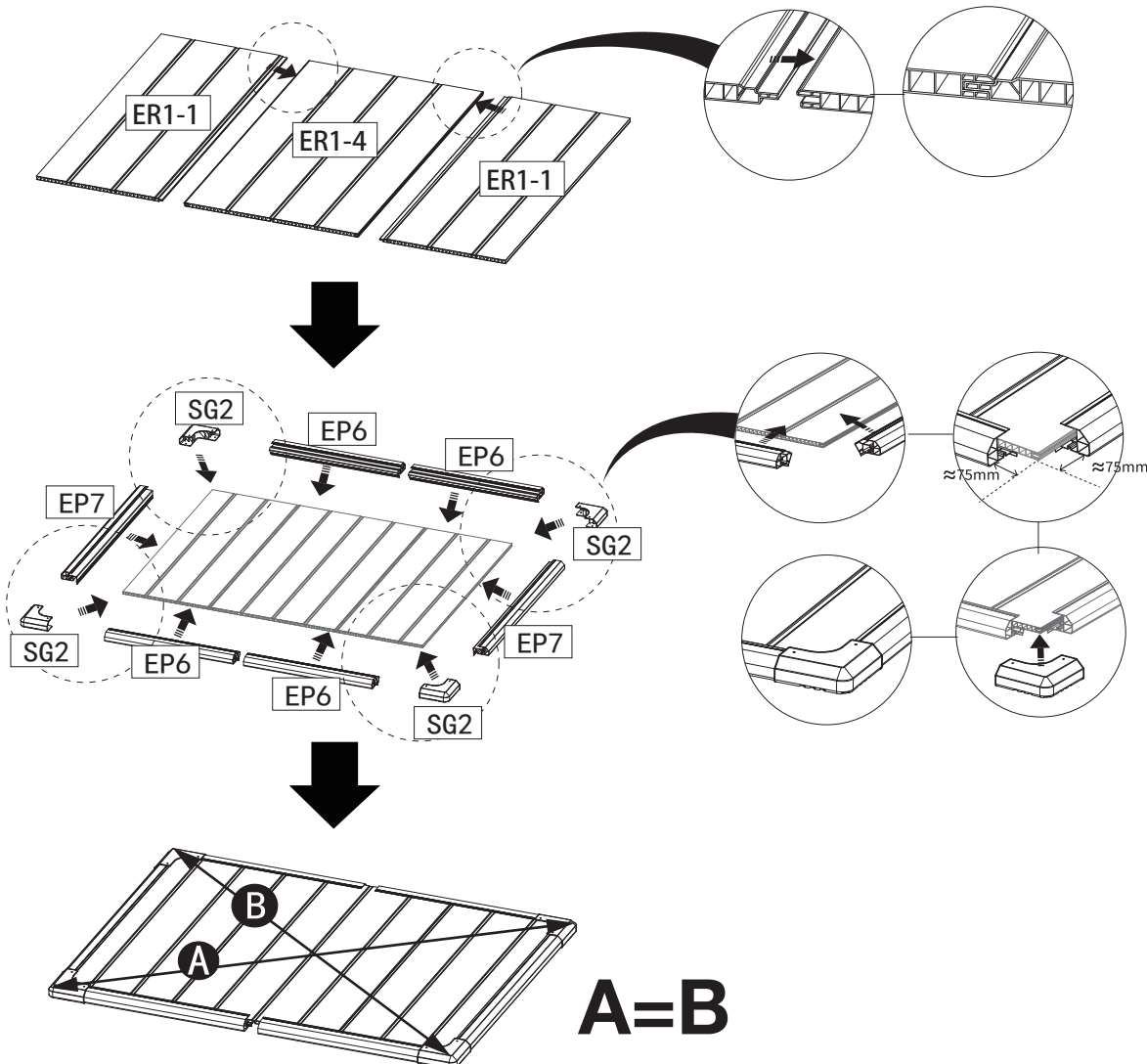

ER1-1		2 PC
ER1-4		1 PC
EP7		2 PC
EP6		4 PC
SG2		4 PC

Step 20 / Schritt 20

Caution: Please use Drill to predrill a hole at depth 1mm before screw.

Achtung: Nutzen Sie den Bohrer, um etwa 1mm Tiefe Löcher vorzubohren, bevor Sie die Schrauben eindrehen.

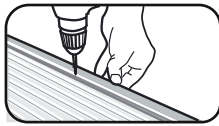

Drive the nails according to the marking lines on the profile.

Die Nägel entlang der Markierungslinien auf dem Profil einschlagen

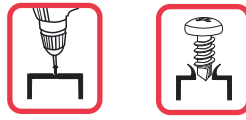
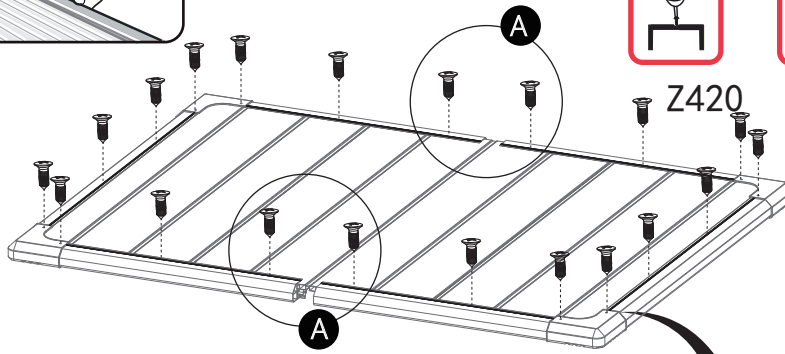

Z410



8 PC

Z420



20 PC

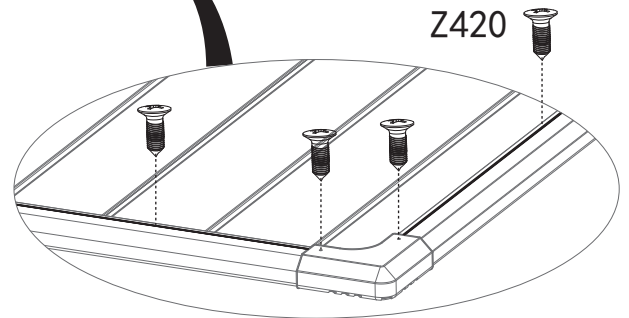
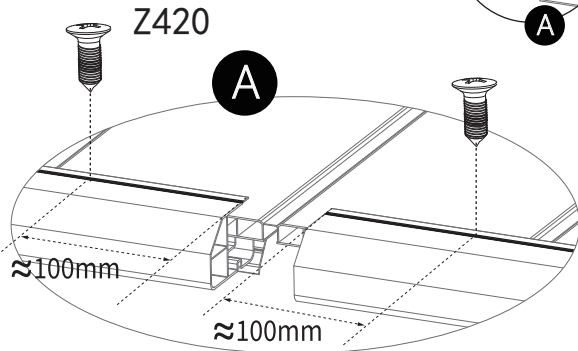

- The distance from the profile edge to the first screw is about 100mm.
- Der Abstand vom Profil zur ersten Schraube sollte 100mm betragen.

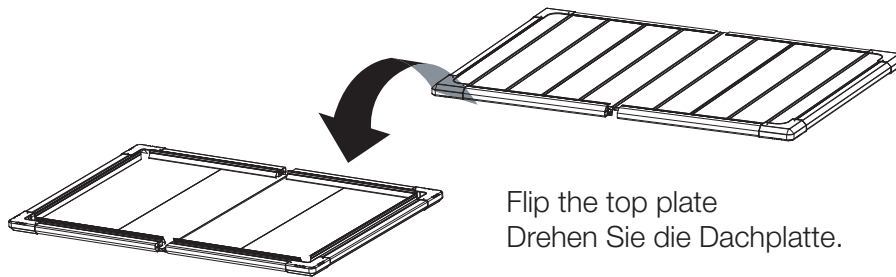

Flip the top plate
Drehen Sie die Dachplatte.

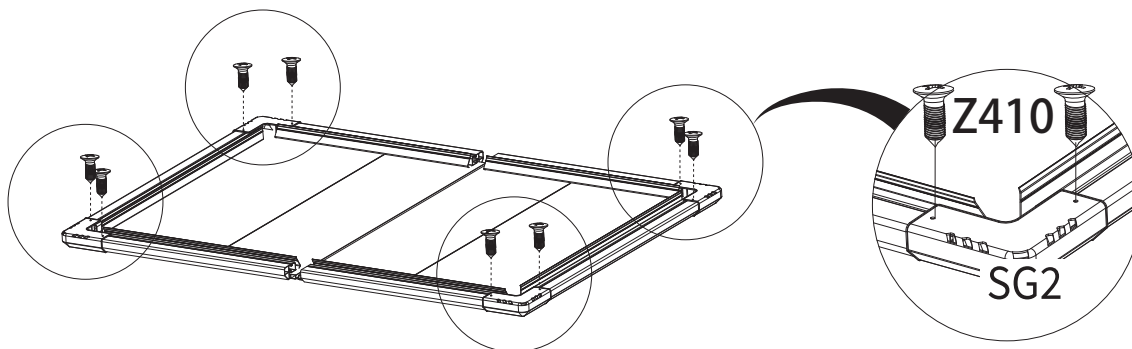

Flip the top plate
Drehen Sie die Dachplatte.

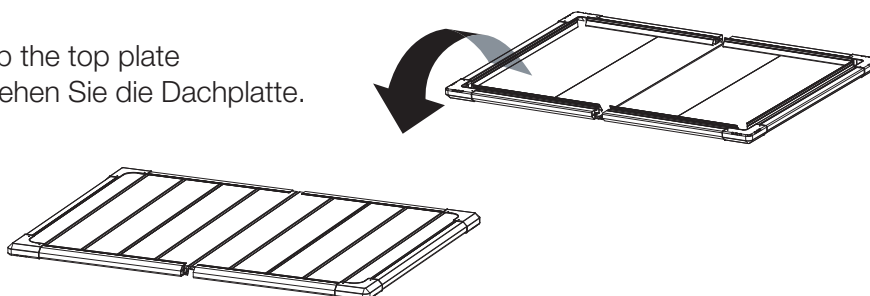

Step 21 / Schritt 21

21-1

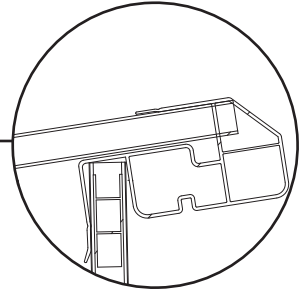
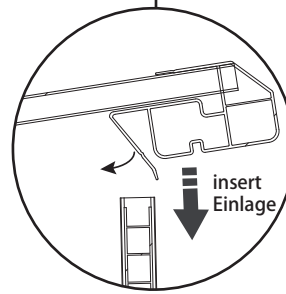
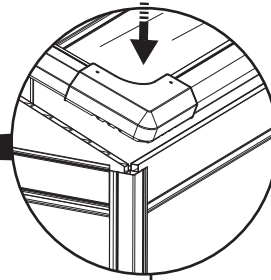
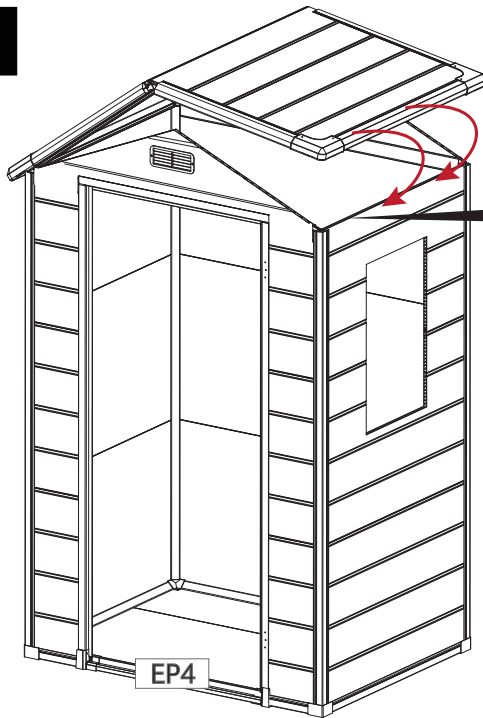

SG8

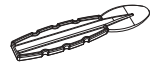

Z420



12 PC

Fully fit the panel inside the profile
Das Paneel muss komplett im Profil liegen.

21-2

Fully fit the panels inside the profiles of roof
Die Paneele vollständig in die Profile des Daches einsetzen

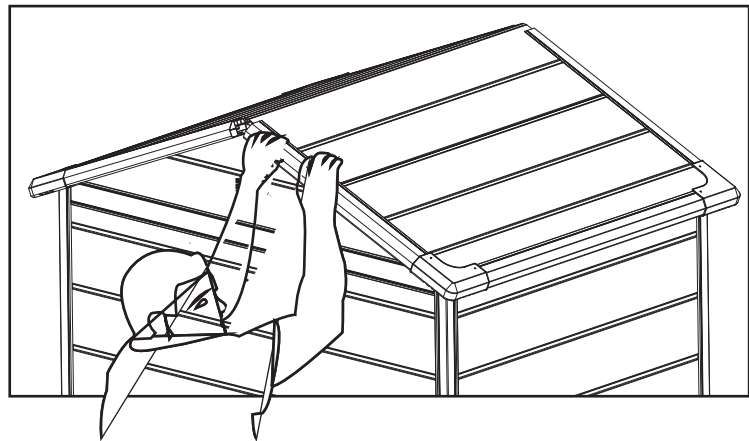
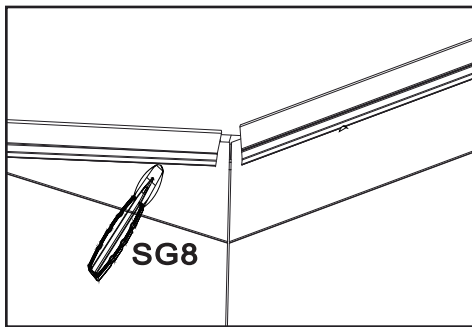

21-3

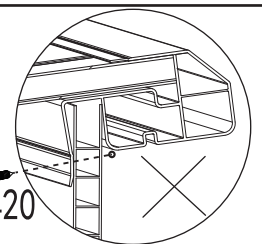
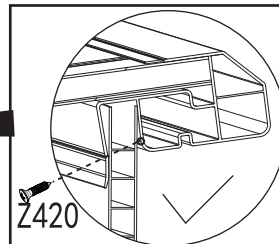
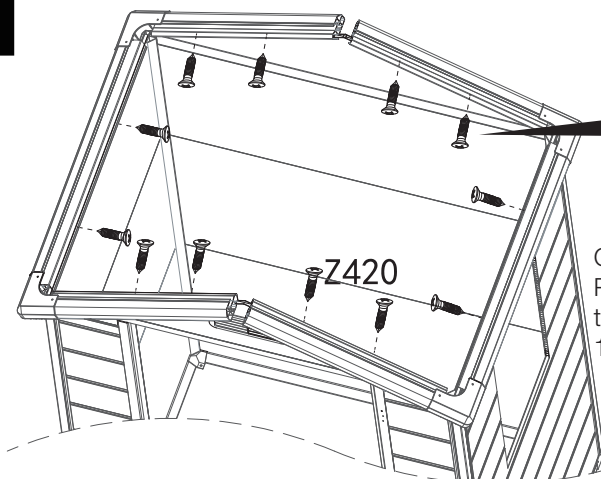

Caution:
Please use Drill
to predrill a hole at depth
1mm before screw.

Achtung:
Nutzen Sie den Bohrer,
Tiefe Löcher vorzubohren, bevor Sie die
Schrauben eindrehen.

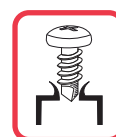

21-4

Z425



4 PC

SG1

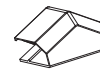

2 PC

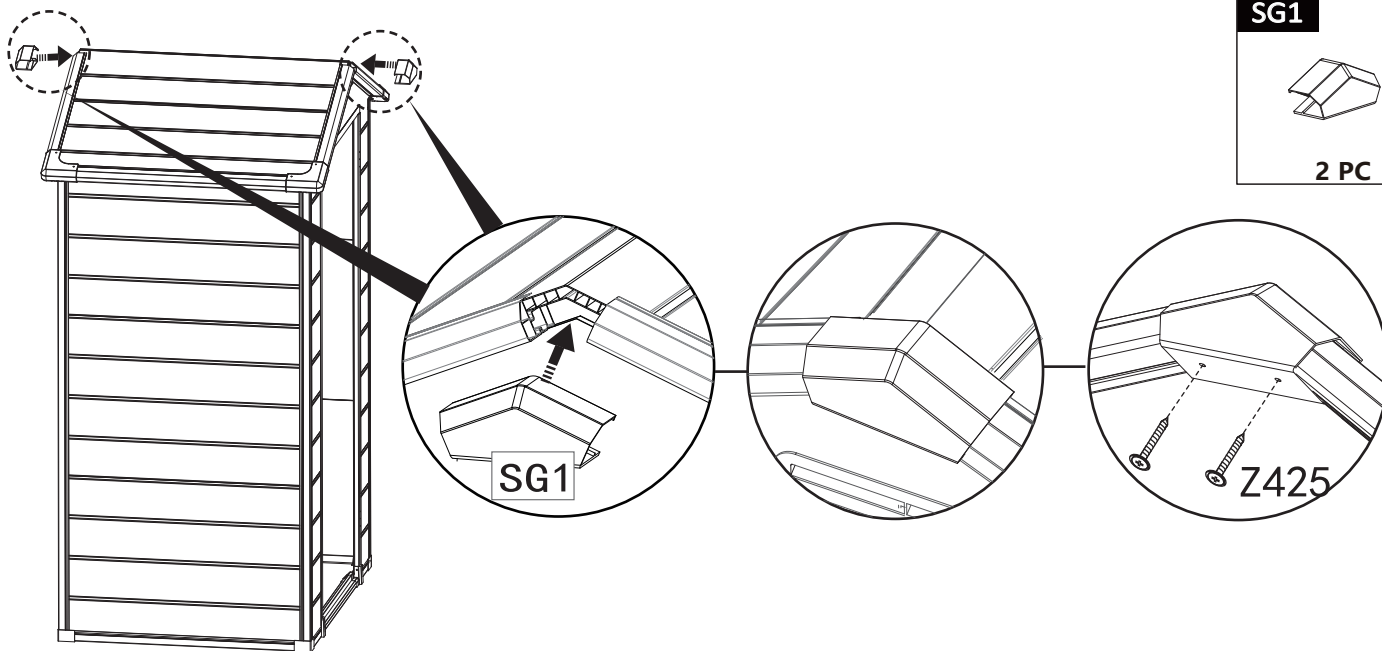

Step 22 / Schritt 22

WINDOW SECTION | FENSTERMONTAGE



SG10

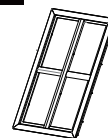

1 PC

1

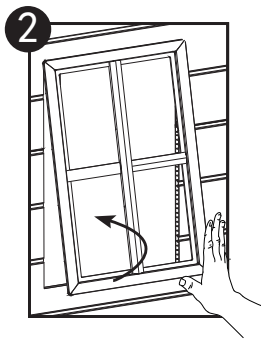
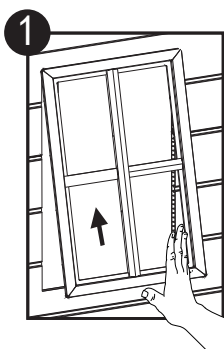

3

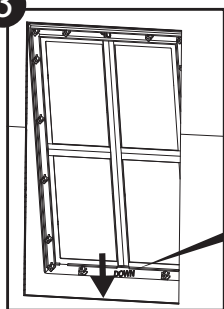

How the Windows look when they are installed
So sieht das Fenster nach der Installation aus.

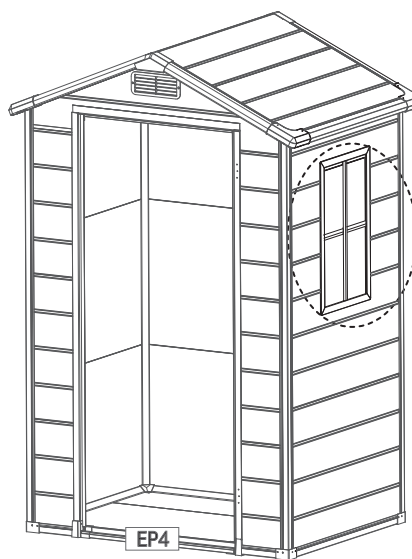

2

- Remove the film before fixing SG101
- Entfernen Sie die Schutzfolie.

- Two persons are needed for this step, to press SG10 from outside and inside.
- Zwei Personen sind für diesen Schritt benötigt um Teil SG10 von innen und außen zu fixieren.

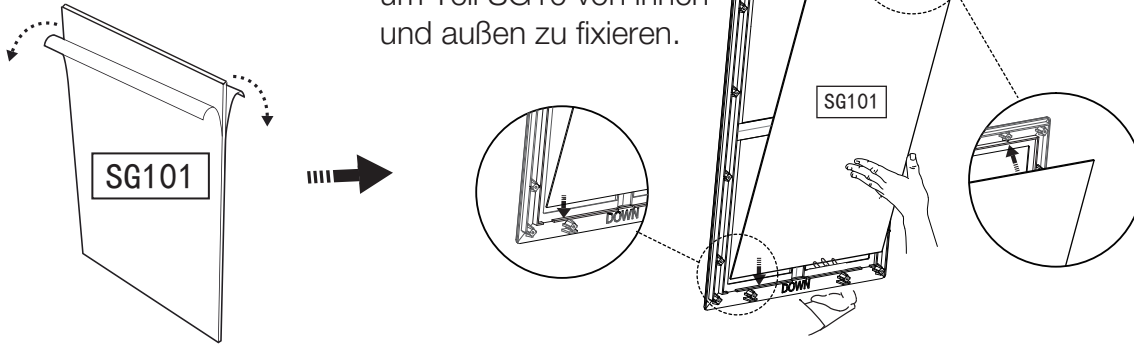

SG101

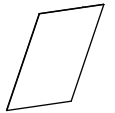

1 PC

SG102

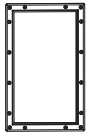

1 PC

Z410



16 PC

3

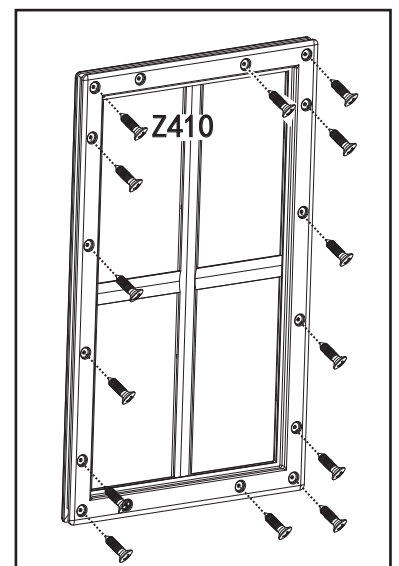
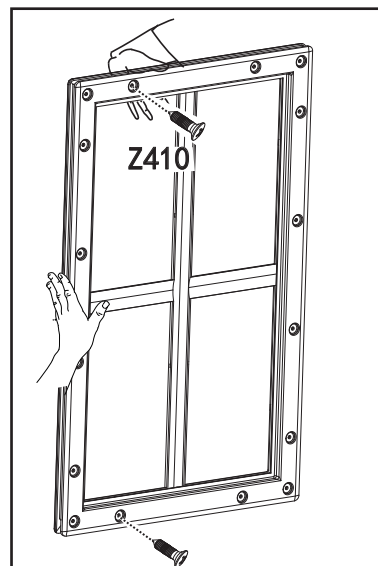
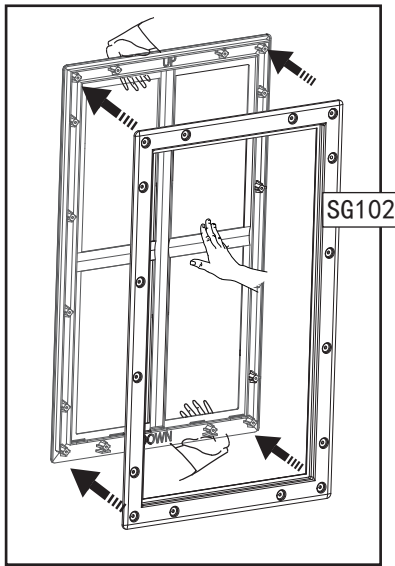

Step 23 / Schritt 23

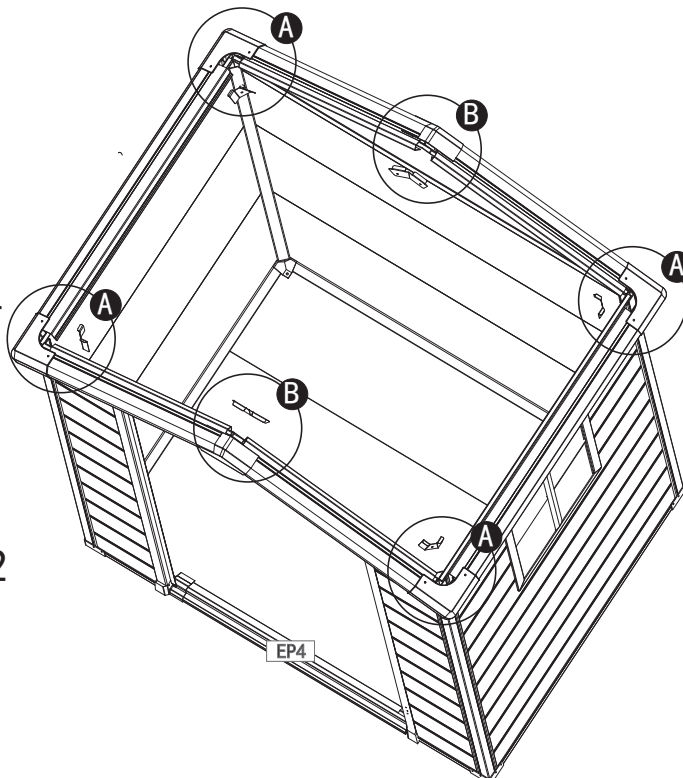
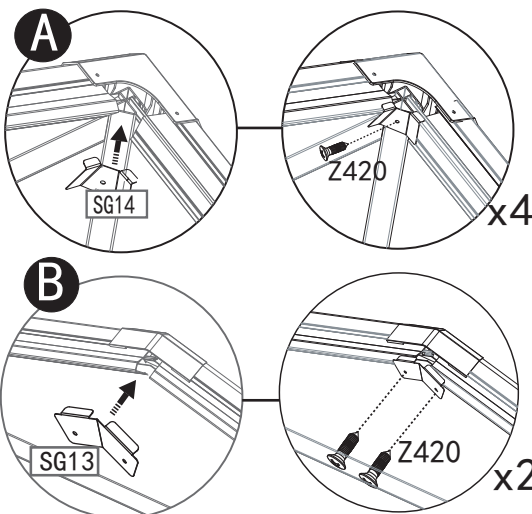

SG14

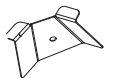

4 PC

SG13



2 PC

Z420



8 PC



Door mount this is above
Hier ist oben.

UP
OBEN



The stripes should be outside
Die gestreifte Seite zeigt nach Außen.

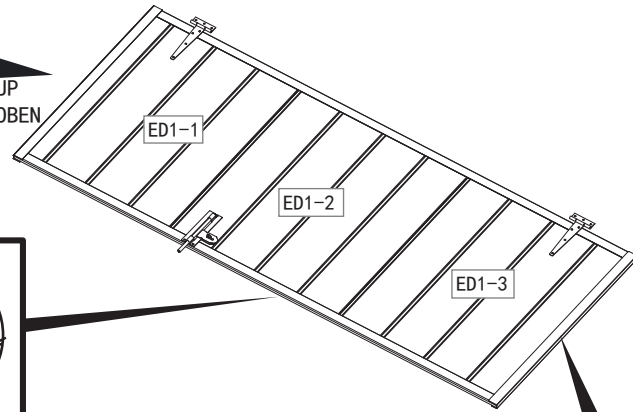

The boards must be straight
Die Paneele müssen gerade ausliegen.

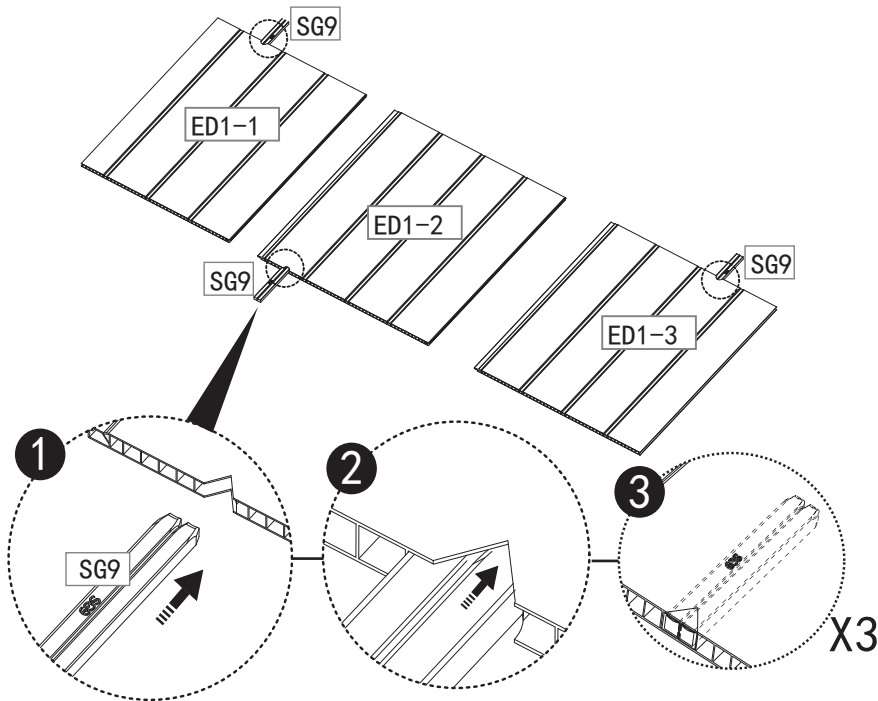

ED1-2 1 PC	ED1-3 1 PC
ED1-1 1 PC	SG9 3 PC

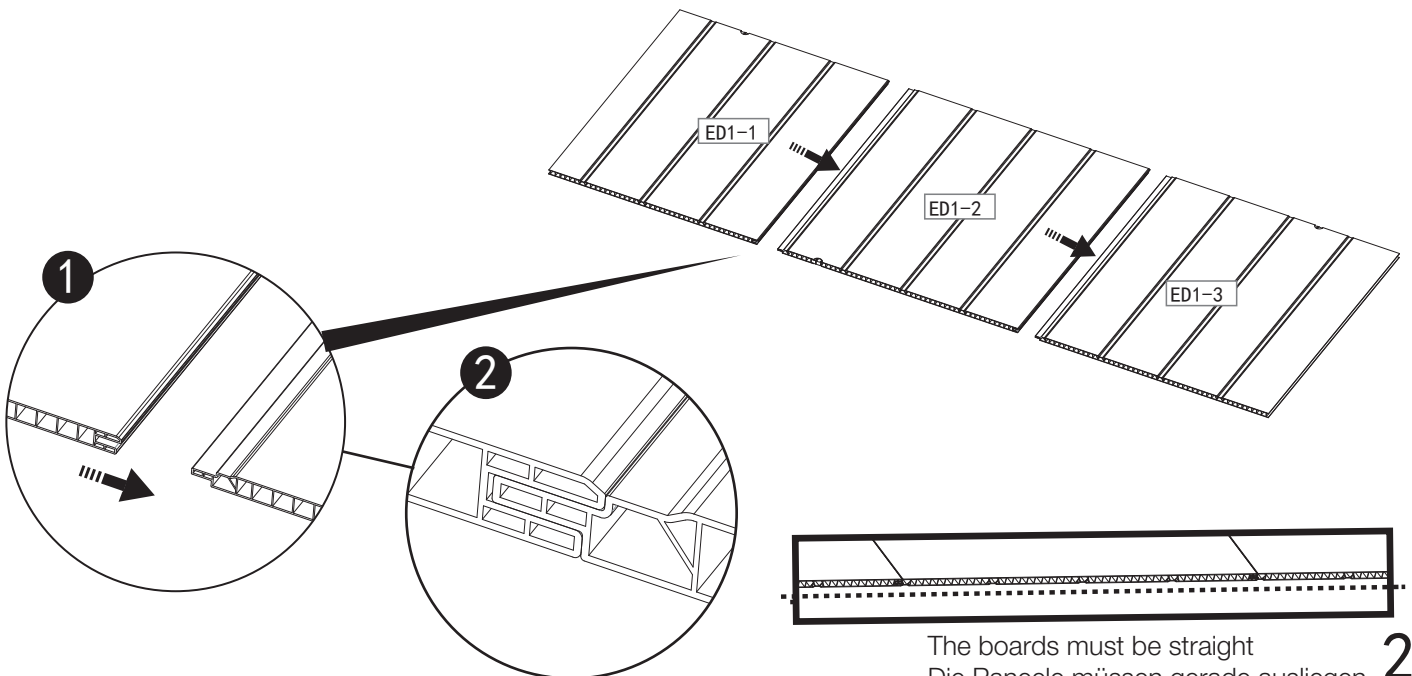

The boards must be straight
Die Paneele müssen gerade ausliegen.

Step 25 / Schritt 25

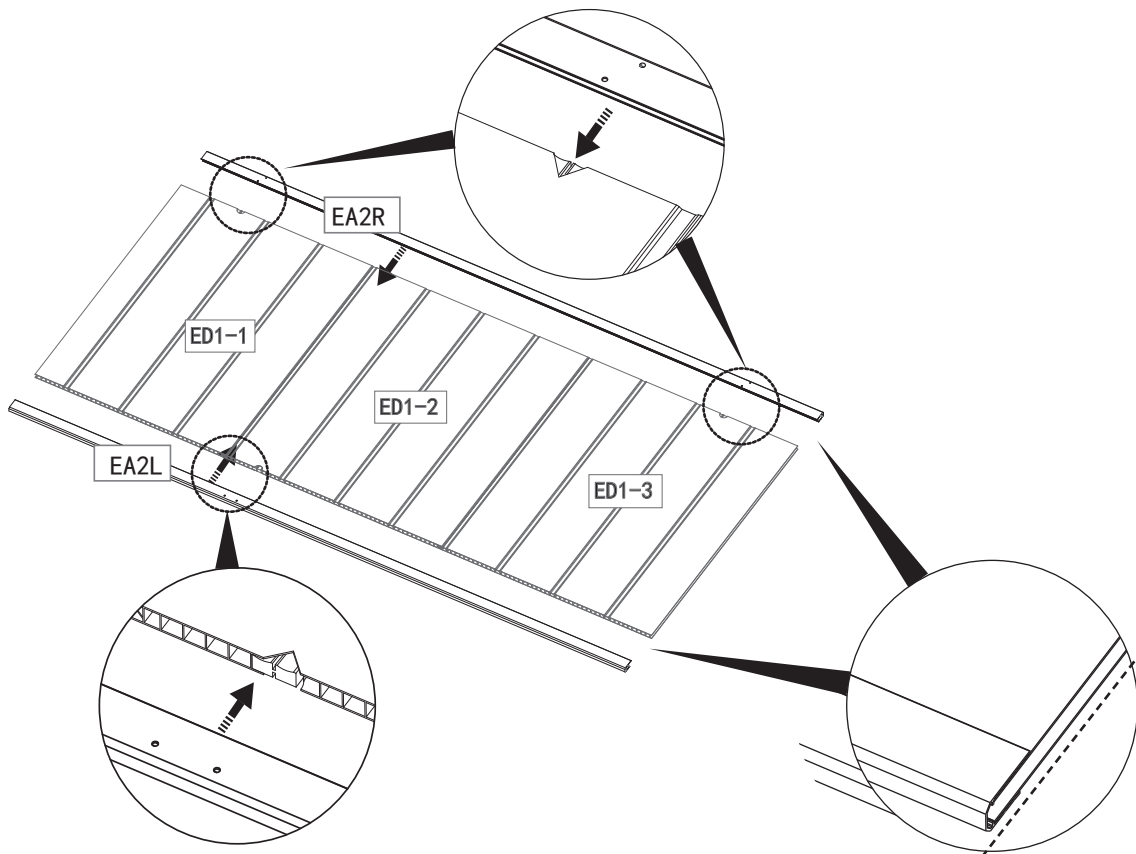

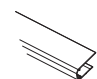
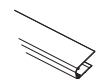
EA2L

1 PC
EA2R

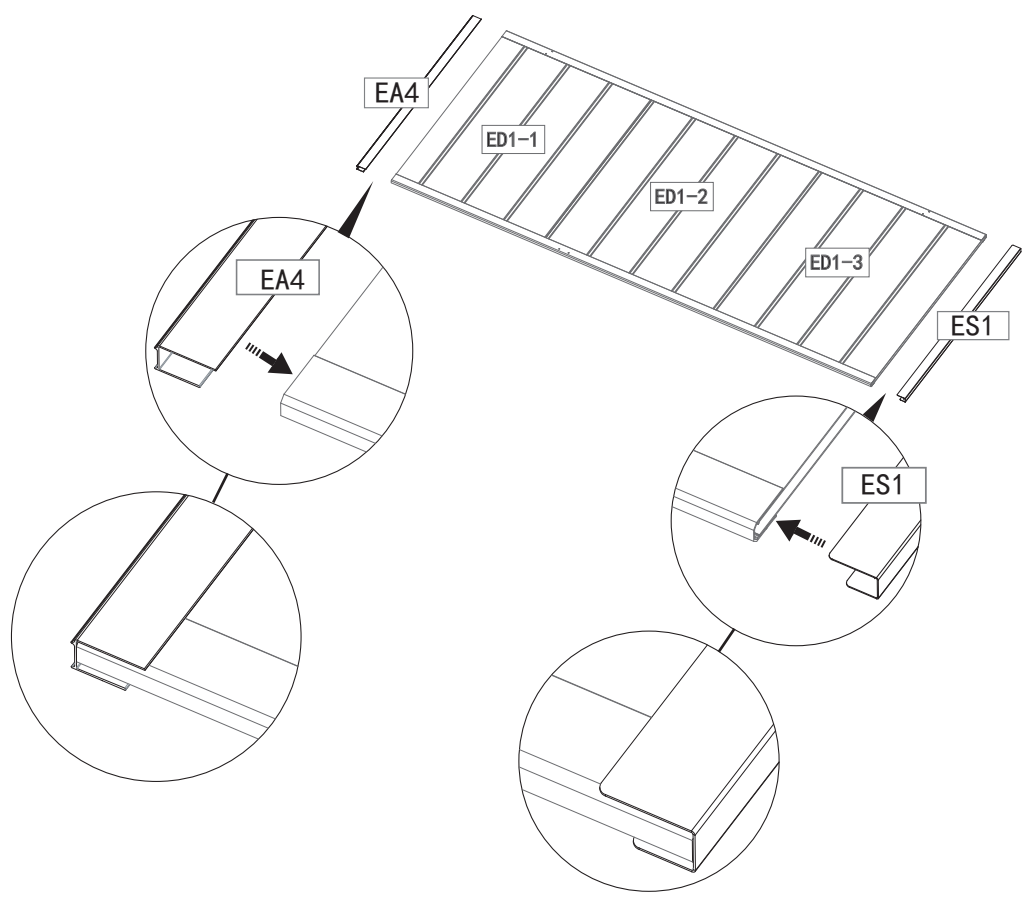
1 PC

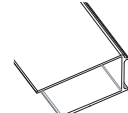
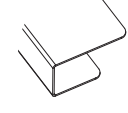
Step 26 / Schritt 26



EA4

1 PC
ES1

1 PC

Step 27 / Schritt 27

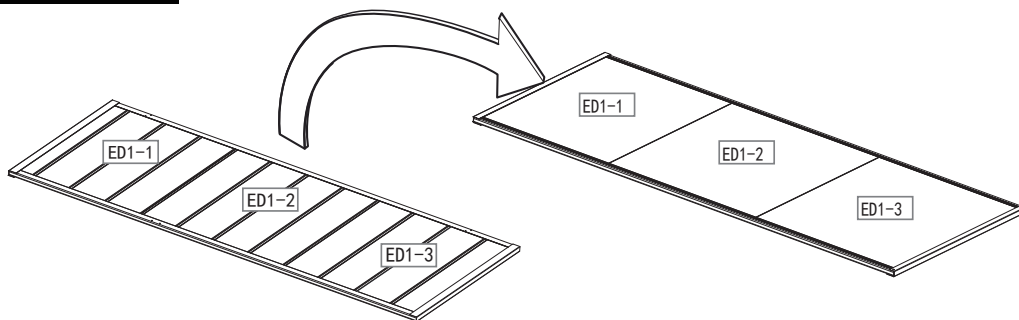
Turn the doors over | Drehen Sie die Tür.

27-1



27-2

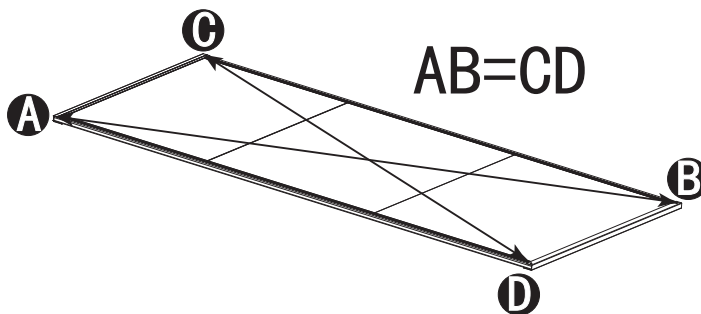

27-3

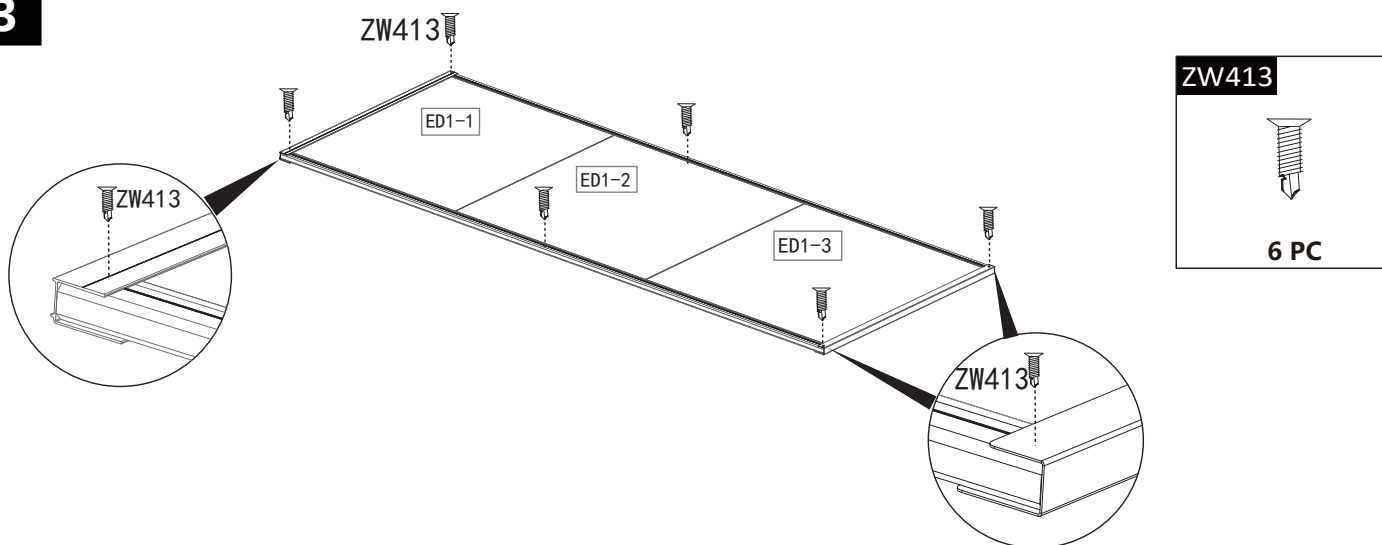

27-4

Turn the doors over
Drehen Sie die Tür.

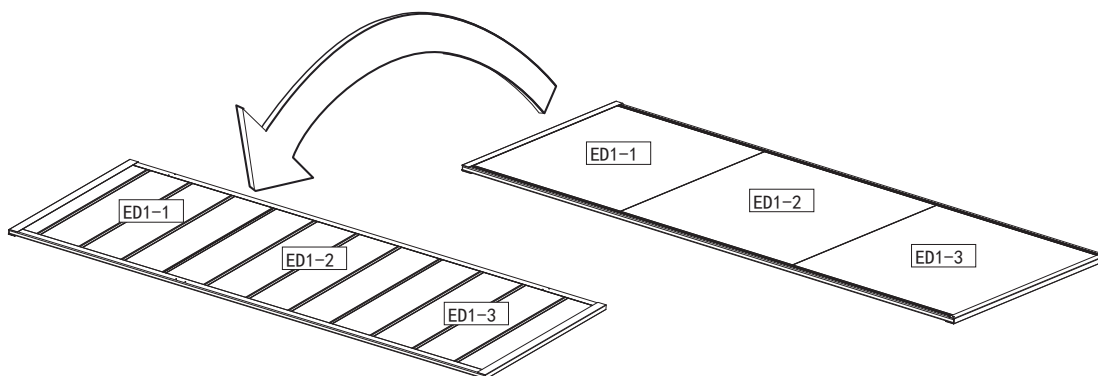

Step 28 / Schritt 28

28-1

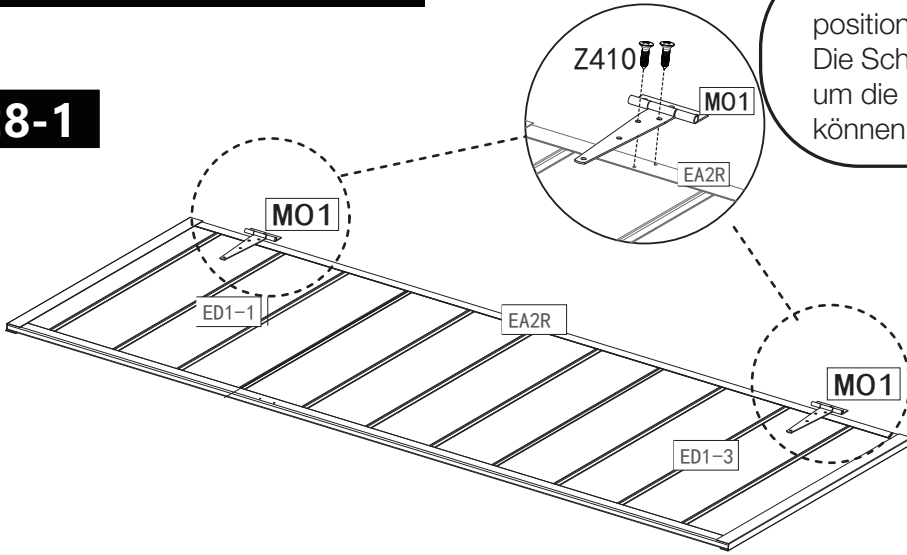

Don't fasten the screws in this step, to adjust the positions of doors
 Die Schrauben in diesem Schritt nicht festziehen, um die Position der Türen noch anpassen zu können.

28-2

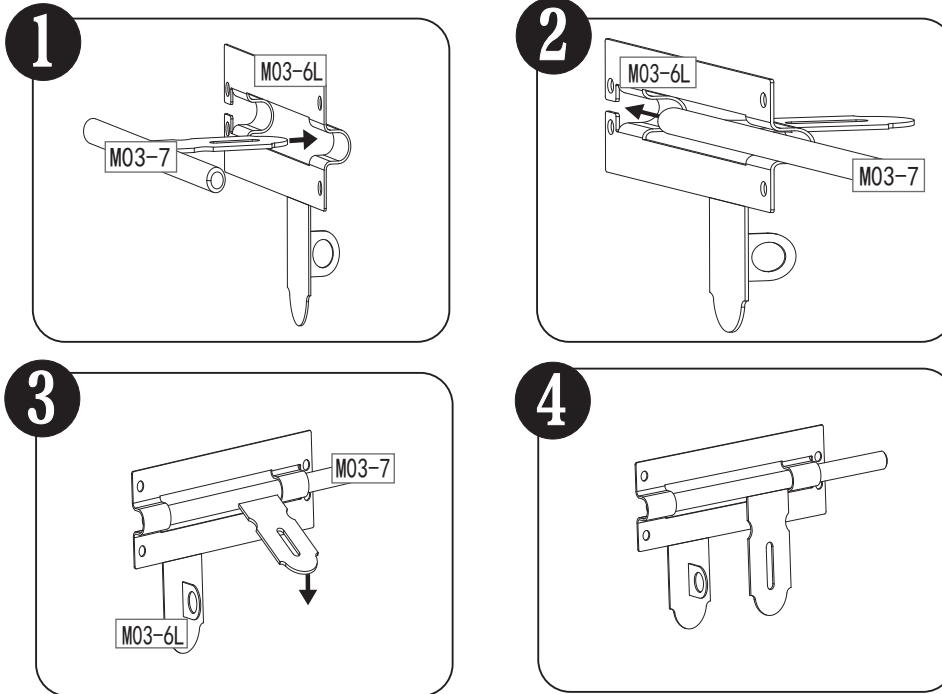

Z410



8 PC

M01

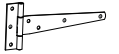

2 PC

M03-6L

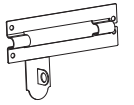

1 PC

M03-7

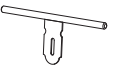

1 PC

28-3

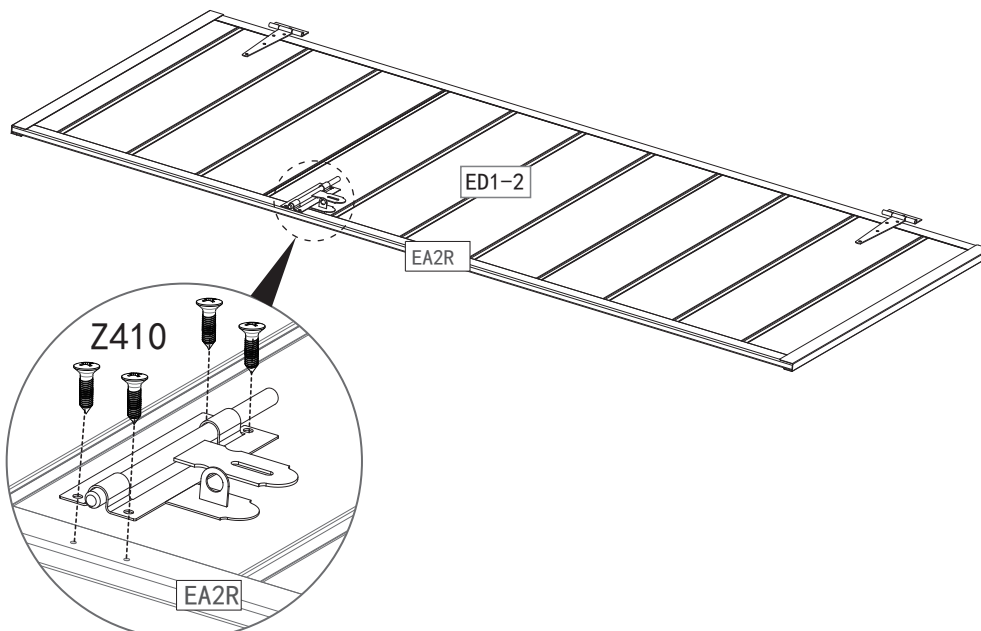

Step 29 / Schritt 29

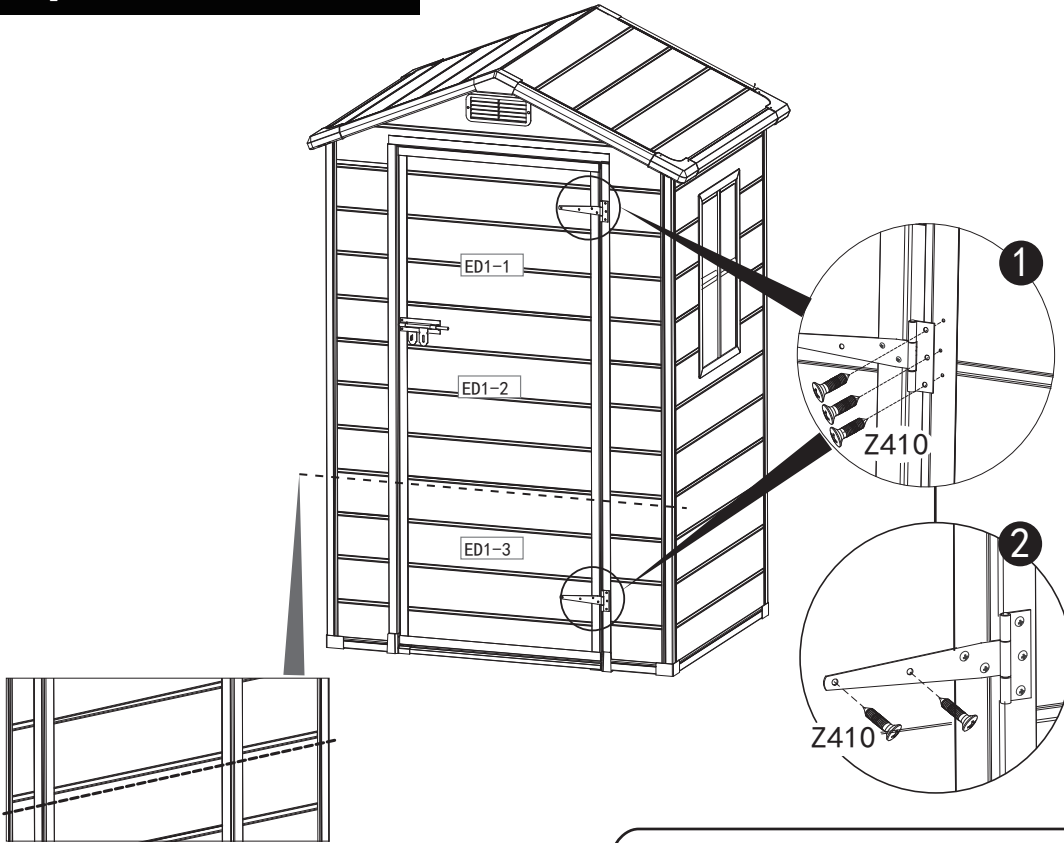

Z410



10 PC

- Grain of the door panels should align with that of the wall panels.
- Achten Sie darauf, dass die Fugen eine Linie bilden.

Nail the door after place adjustment and fasten all the screws.
Tür nach Justierung festnageln und alle Schrauben anziehen.

Step 30 / Schritt 30

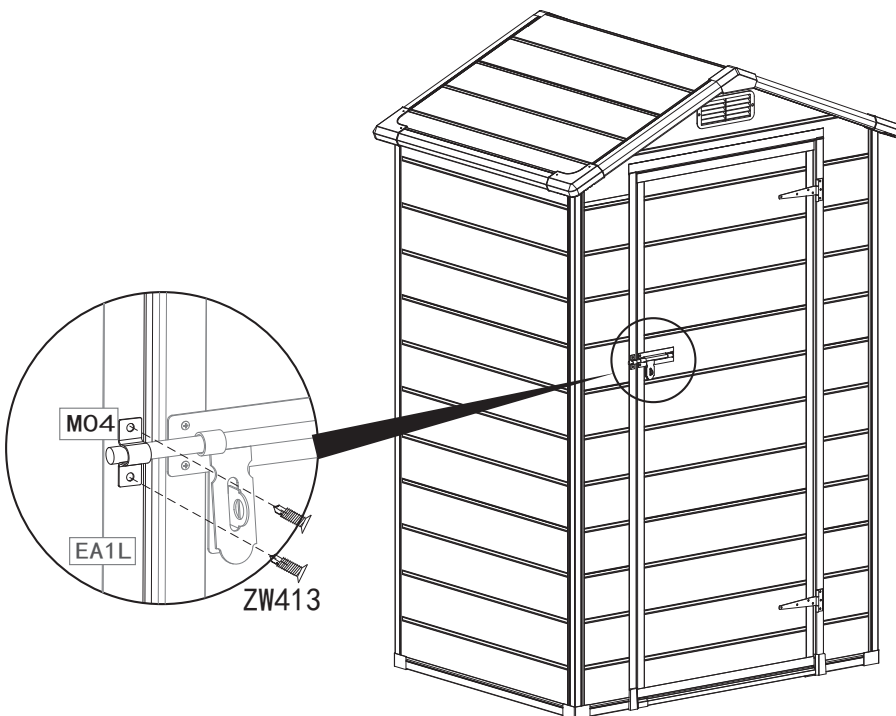

M04



1 PC

ZW413



2 PC

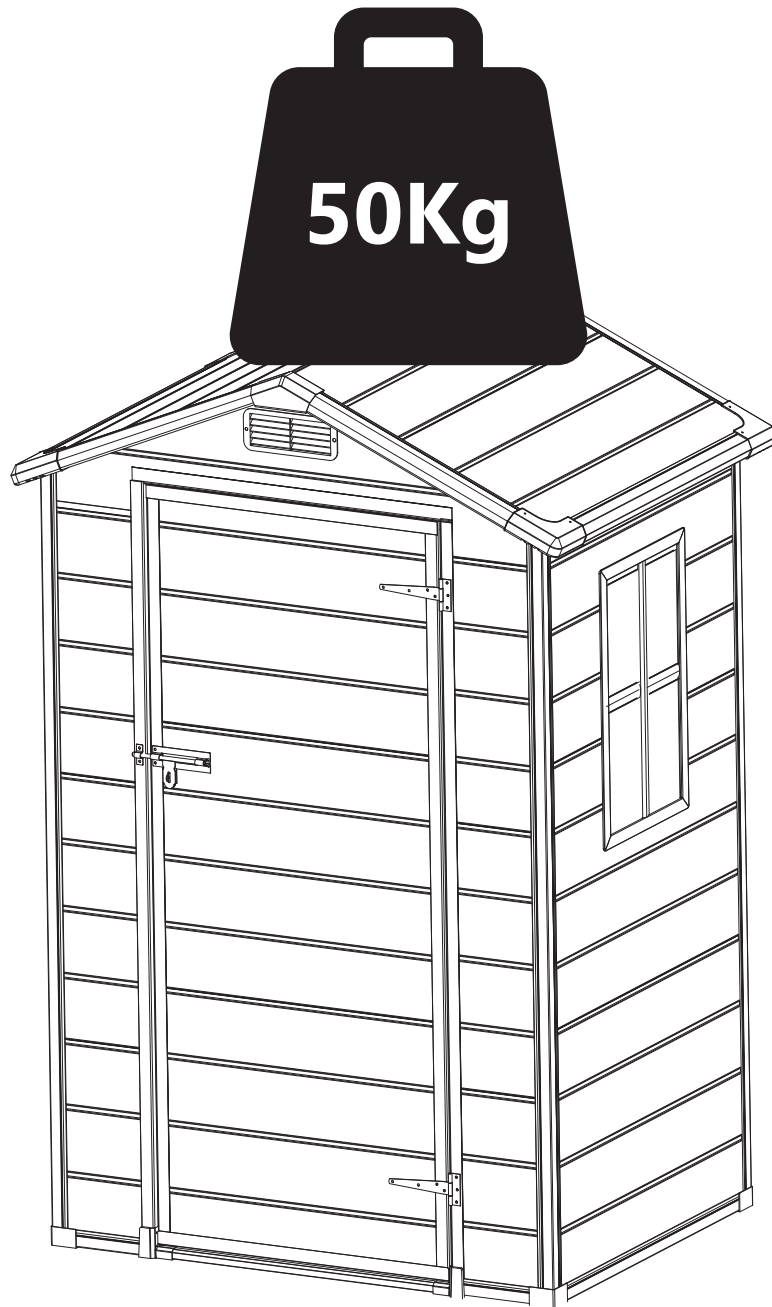

Sicherheitshinweis:

ACHTUNG: Lesen Sie alle Sicherheitshinweise und Anweisungen.

Versäumnisse bei der Einhaltung können schwere Verletzungen verursachen

1. **Vollständigkeit.** *Prüfen Sie vor der Montage die Teile auf Vollständigkeit und Unversehrtheit.*
2. **Vorsicht.** *Achten Sie während der gesamten Montage, insbesondere beim Heben schwerer oder langer Teile darauf, dass Sie sich oder andere nicht verletzen.*
3. **Werkzeug und Hilfe.** *Leiter und Werkzeug sollen nur als Hilfestellung dienen. Wenn möglich, lassen Sie sich bei der Montage von mindestens einer weiteren Person unterstützen.*
4. **Kinder.** *Achten Sie darauf, dass sich keine Kinder während des Aufbaus in der Nähe befinden. Der Aufbau sollte nur von Erwachsenen durchgeführt werden.*
5. **Aufbau.** *Der Aufbau sollte durch 2 Personen erfolgen.*